

MEMORIAL DESCRITIVO DO TERRENO:

Datum: SAD-69 Meridiano Central: 51° WGr

Estação	Vante	Coord. Norte	Coord. Este	Azimute	Distância	Fator Escala	Latitude	Longitude
0=PP	1	7.221.504,644	584.512,267	358°24'19"	83,34	0,99968772	25°07'11,60973" S	50°09'42,13141" W
1	2	7.221.587,054	584.509,948	175°1'10"	18,64	0,99968771	25°07'08,90198" S	50°09'42,23269" W
2	3	7.221.605,688	584.515,694	46°10'40"	116,38	0,99968772	25°07'08,32432" S	50°09'42,03146" W
3	4	7.221.686,271	584.599,680	166°49'35"	79,18	0,99968790	25°07'05,68778" S	50°09'38,05126" W
4	5	7.221.609,171	584.617,706	76°58'25"	34,12	0,99968793	25°07'08,18049" S	50°09'38,38880" W
5	6	7.221.616,882	584.650,948	166°49'06"	77,61	0,99968800	25°07'07,83310" S	50°09'37,20457" W
0=PP		7.221.541,415	584.668,623	256°45'58"	160,62	0,99968804	25°07'10,38279" S	50°09'36,55670" W

ESTATÍSTICA:

ÁREA = 16.927,39 m2  
PERÍMETRO = 569,79 m

OBRA:	PLANTA TOPOGRÁFICA	DESENHO:	VALMR
TÍTULO:	PLANIMETRIA ANTIGO SISTEMA GEODÉSICO BRASILEIRO UTM-SAD - MC 51° W	DATA:	09/06/2020
PROP.:	TRIBUNAL DE JUSTIÇA DO ESTADO DO PARANÁ BAIRRO DE OFICINAS - PONTA GROSSA - PARANÁ	ESCALA(S):	1:1000
RESP. TÉCNICO:	FÁBIO MOREIRA RABELO - ENGENHEIRO CIVIL - CREA(RJ) 1994104196	FOLHA:	1



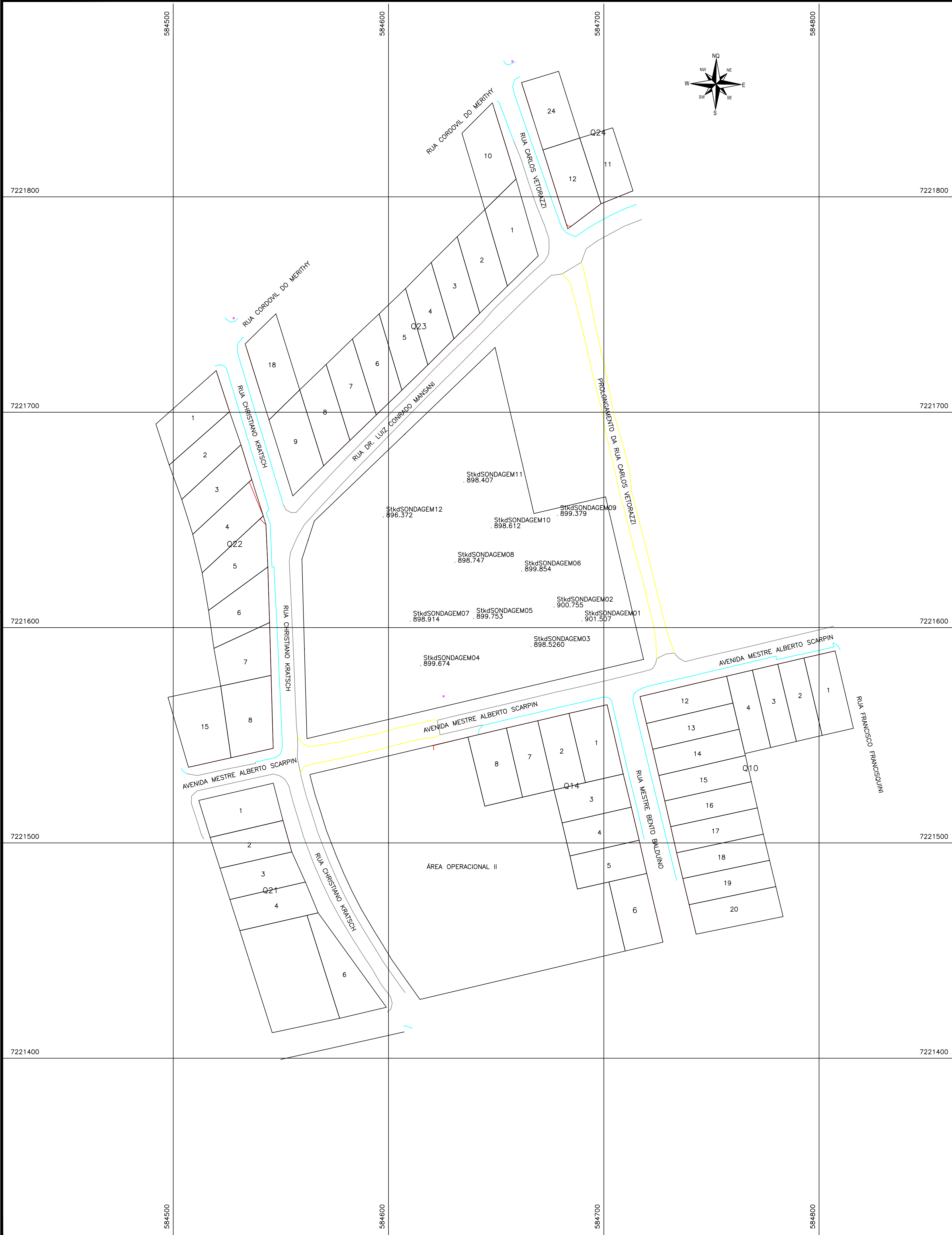

COORDENADAS / SONDAGEM:				
DESCRIÇÃO	NORTE	LESTE	COTA	DATA
SkdSONDAGEM01	7221603.045	584699.806	901.507	06 03 2020
SkdSONDAGEM02	7221608.512	584676.829	900.755	06 03 2020
SkdSONDAGEM03	7221591.145	584666.145	901.172	06 03 2020
SkdSONDAGEM04	7221582.327	584614.883	899.674	06 03 2020
SkdSONDAGEM05	7221604.255	584639.462	899.753	06 03 2020
SkdSONDAGEM06	7221626.248	584661.887	899.854	06 03 2020
SkdSONDAGEM07	7221602.917	584610.047	898.514	06 03 2020
SkdSONDAGEM08	7221630.258	584630.835	898.747	06 03 2020
SkdSONDAGEM09	7221651.997	584676.384	899.379	06 03 2020
SkdSONDAGEM10	7221646.287	584647.703	898.512	06 03 2020
SkdSONDAGEM11	7221667.510	584634.941	898.407	06 03 2020
SkdSONDAGEM12	7221651.297	584597.549	896.372	06 03 2020

ESTATÍSTICA:

ÁREA = 16.927,39 m2  
PERÍMETRO = 569,79 m

OBRA:	PLANTA TOPOGRÁFICA	DESENHO: VALMR
TÍTULO:	PONTOS DE SONDAGEM GEOTÉCNICA ANTIGO SISTEMA GEODÉSICO BRASILEIRO UTM-SAD-69 - MC 51° W	DATA: 09/06/2020
PROP.:	TRIBUNAL DE JUSTIÇA DO ESTADO DO PARANÁ BAIRRO DE OFICINAS - PONTA GROSSA - PARANÁ	ESCALA(S): 1:1000
RESP. TÉCNICO:	FÁBIO MOREIRA RABELO - ENGENHEIRO CIVIL - CREA(RJ) 1994104196	FOLHA: 2





CONVENÇÕES:	
◦000.00	PONTO COTADO
◦000.00 RN	REFERÊNCIAS DE NÍVEL MATERIALIZADAS POR PARAFUSOS DE AÇO TIPO PHILIPS CRAVADOS NO ASFALTO
ESTATÍSTICA:	
ÁREA = 16.927,39 m2 PERÍMETRO = 569,79 m	
OBRA:	PLANTA TOPOGRÁFICA
DESENHO:	VALMR
TÍTULO:	LEVANTAMENTO PLANALTIMÉTRICO INTERVALO VERTICAL DAS CURVAS = 0,5 METRO E PONTOS COTADOS ANTIGO SISTEMA GEODÉSICO BRASILEIRO UTM-SAD-69 - MC 51° W
DATA:	09/06/2020
PROP.:	TRIBUNAL DE JUSTIÇA DO ESTADO DO PARANÁ BAIRRO DE OFICINAS - PONTA GROSSA - PARANÁ
ESCALA(S):	1:1000
RESP. TÉCNICO:	FABIO MOREIRA RABELO - ENGENHEIRO CIVIL - CREA(RJ) 1994104196
FOLHA:	3







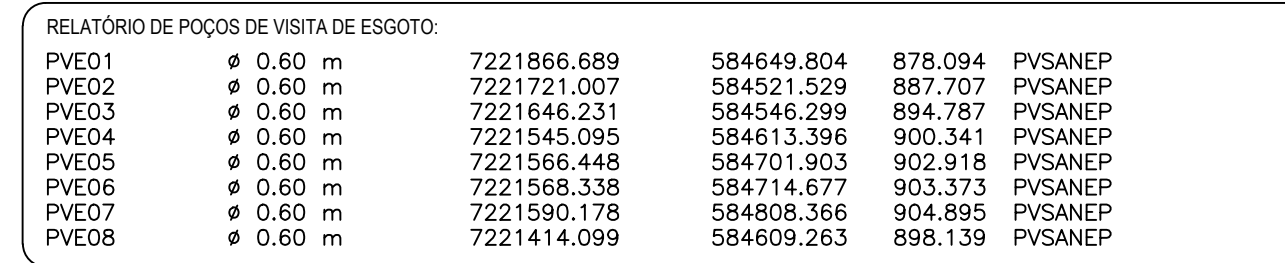
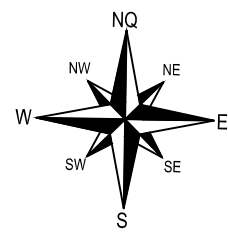



ESTATÍSTICA:		<div><div></div> CAPÃO DE MATO = 6.412,14 m2</div> <div><div></div> CAMPO BRUTO = 10.515,25 m2</div> <div>ÁREA TOTAL = 16.927,39 m2</div>
OBRA:	PLANTA TOPOGRÁFICA	DESENHO: VALMR
TÍTULO:	VEGETAÇÃO ANTIGO SISTEMA GEODÉSICO BRASILEIRO UTM-SAD-69 - MC 51°W	DATA: 09/06/2020
PROP.:	TRIBUNAL DE JUSTIÇA DO ESTADO DO PARANÁ BAIRRO DE OFICINAS - PONTA GROSSA - PARANÁ	ESCALA(S): 1:1000
RESP. TÉCNICO:	FÁBIO MOREIRA RABELO - ENGENHEIRO CIVIL - CREA(RJ) 1994104196	FOLHA: 4





RELATÓRIO DA CAPTAÇÃO PLUVIAL					
BL01	ENTUPIDA	722.1840,293	584653,026	880,840	BOCA-DE-LOBO
BL02	-1,30 m	722.1835,076	584662,670	882,457	BOCA-DE-LOBO
BL03	-1,81 m	722.1829,889	584660,090	885,680	BOCA-DE-LOBO
BL04	ENTUPIDA	722.1791,769	584670,211	887,707	BOCA-DE-LOBO
BL05	LACRADA	722.1790,104	584679,267	888,516	LACRADA
BL06	ENTUPIDA	722.1757,561	584684,995	891,325	BOCA-DE-LOBO
BL07	-1,02 m	722.1760,179	584691,171	890,889	BOCA-DE-LOBO
BL08	-0,80 m	722.1754,082	584665,384	891,090	BOCA-DE-LOBO
BL09	-0,90 m	722.1703,769	584658,342	893,359	BOCA-DE-LOBO
BL10	-1,07 m	722.1697,727	584609,038	893,142	BOCA-DE-LOBO
BL11	INACESSÍVEL	722.1715,801	584526,616	888,276	BOCA-DE-LOBO
BL12	INACESSÍVEL	722.1717,901	584538,328	888,294	BOCA-DE-LOBO
BL13	INACESSÍVEL	722.1660,820	584543,093	892,685	BOCA-DE-LOBO
BL14	INACESSÍVEL	722.1621,183	584547,392	895,063	BOCA-DE-LOBO
BL15	-0,80 m	722.1429,938	584598,849	898,020	BOCA-DE-LOBO

CONVENÇÕES:		LINHAS AÉREAS
		MEIO-FIO
		MONUMENTO
		POSTE
		POÇO DE VISITA DE ESCOTO
		POÇO DE VISITA DE TELEFONE
		TALUDE
		VIA NÃO PAVIMENTADA
		VIA PAVIMENTADA

A1841 x 594 mm







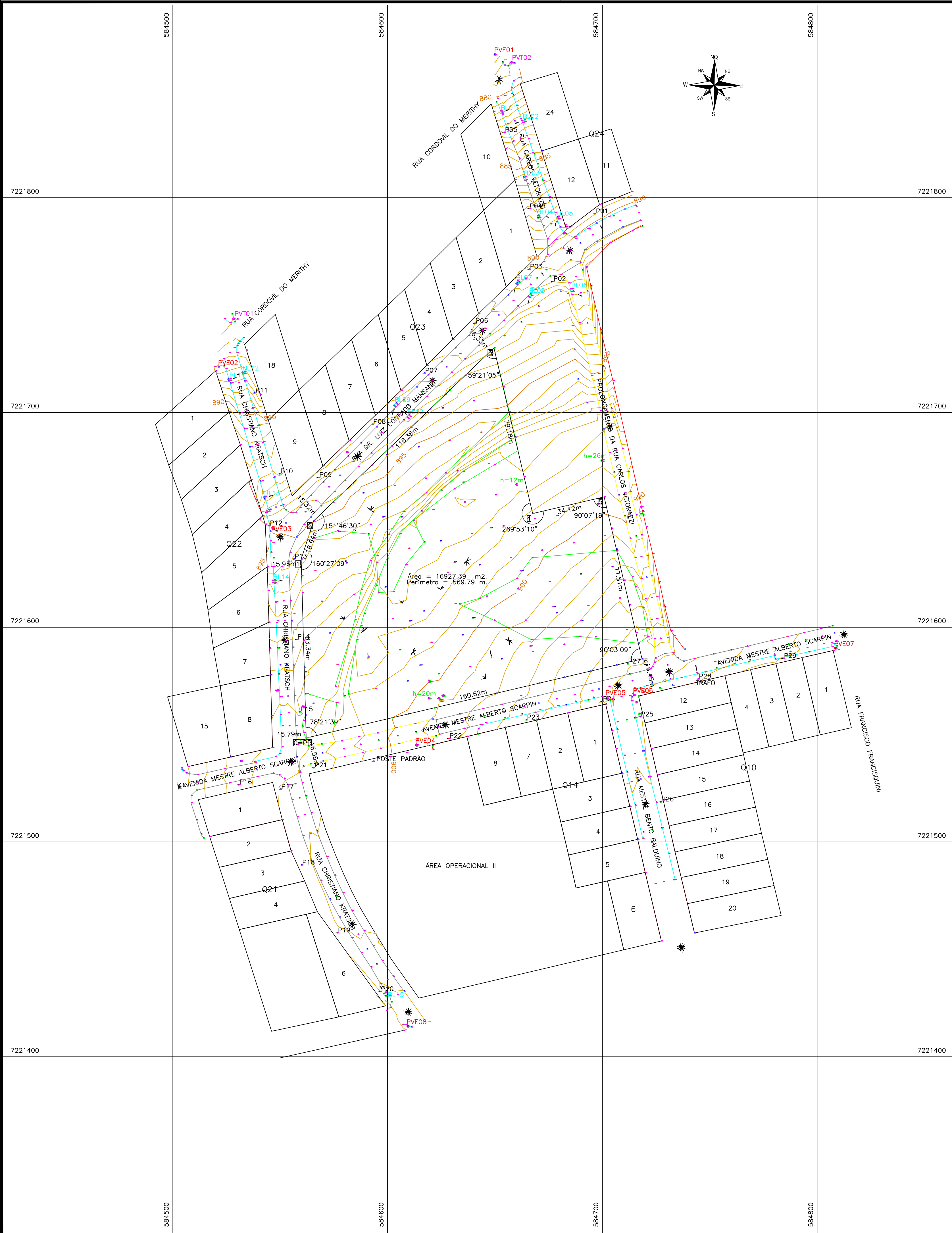

RELATÓRIO DA CAPTAÇÃO PLUVIAL:					
BL01	ENTUPIDA	7221796.4960	584603.1730	878.1940	BOCA-DE-LOBO
BL02	-1,30 m	7221792.0920	584612.5200	879.6670	BOCA-DE-LOBO
BL03	-1,80 m	7221766.0720	584614.1560	883.0340	BOCA-DE-LEÃO
BL04	ENTUPIDA	7221747.8720	584620.3880	885.0610	BOCA-DE-LEÃO
BL05	LACRADA	7221747.1650	584629.0540	885.7770	LACRADA
BL06	ENTUPIDA	7221713.7640	584635.1420	888.6790	BOCA-DE-LEÃO
BL07	-1,00 m	7221716.2880	584608.5740	888.0980	BOCA-DE-LEÃO
BL08	-0,90 m	7221710.2850	584615.5310	888.4440	BOCA-DE-LEÃO
BL09	-0,80 m	7221659.5060	584552.9370	890.4870	BOCA-DE-LEÃO
BL10	-0,70 m	7221653.6300	584558.1850	890.4960	QUEBRADA
BL11	INACESSÍVEL	7221672.0110	584476.7630	885.6300	BOCA-DE-LOBO
BL12	INACESSÍVEL	7221674.9330	584482.2060	885.5800	BOCA-DE-LOBO
BL13	INACESSÍVEL	7221617.0230	584493.2400	890.0390	BOCA-DE-LOBO
BL14	INACESSÍVEL	7221578.0350	584497.5390	893.0170	BOCA-DE-LOBO
BL15	-0,80 m	7221386.1410	584548.9960	895.3740	BOCA-DE-LEÃO

RELATÓRIO DO POSTEAMENTO:					
P01	26-06-2001	1050	300	doN	7221748.7080
P02	04-07-2001	1050	600	doN	7221717.1920
P03	13-07-2001	1050	150	doN	7221722.9220
P04	11-08-2001	1050	150	doN	7221751.0510
P05	11-08-2001	1050	150	doN	7221786.5940
P06	13-07-2001	1050	600	doN	7221697.7330
P07	02-09-2002	1050	150	doN	7221674.5160
P08	02-09-2002	1050	150	doN	7221650.7070
P09	ILEGÍVEL				7221625.9240
P10	30-11-2000	900	150	doN	7221627.6210
P11	30-11-2000	900	150	doN	7221665.2390
P12	17-08-2002	1050	600	doN	7221603.3960
P13	30-10-2000	900	300	doN	7221587.9410
P14	07-01-1993	900	150	doN	7221550.5110
P15	13-07-2001	1050	600	doN	7221516.7980
P16	03-09-2002	1050	150	doN	7221482.8420
P17	13-08-2002	1050	300	doN	7221480.7530
P18	14-08-2002	1050	300	doN	7221445.4440
P19	14-08-2002	1050	300	doN	7221413.8680
P20	05-08-2002	1050	150	doN	7221386.5090
P21	12-08-2002	1050	300	doN	7221490.7750
P22	14-08-2002	1050	300	doN	7221504.3810
P23	03-09-2002	1050	150	doN	7221513.0170
P24	28-10-1985	900	150	doN	7221521.6120
P25	06-11-1985	900	150	doN	7221514.4440
P26	06-11-1985	900	150	doN	7221474.8580
P27	22-11-1998	900	150	doN	7221539.0710
P28	05-04-2007	1200	600	doN	7221532.0740
P29	28-11-1985	1050	300	doN	7221541.6420

MEMORIAL DESCRITIVO DO TERRENO:

Datum: SIRGAS2000 Meridiano Central: 51° Wgr

EstaçãoCoord. Norte Coord. Este Azimute Distância Fator Escala Latitude Longitude

0=PP1 7.221.504,644 584.512,267 358°24'19" 83,34 0,99968772 25°07'11,92202"S 50°09'42,11835"W

1 2 7.221.587,954 584.509,948 175°57'10" 18,64 0,99968771 25°07'09,21425"S 50°09'42,21963"W

2 3 7.221.605,688 584.515,694 46°10'40" 116,38 0,99968772 25°07'08,63659"S 50°09'42,01840"W

3 4 7.221.686,271 584.599,660 166°49'35" 79,18 0,99968790 25°07'06,00005"S 50°09'39,03819"W

4 5 7.221.699,171 584.617,706 76°56'25" 34,12 0,99968793 25°07'08,50276"S 50°09'38,37672"W

5 6 7.221.616,882 584.650,948 166°49'06" 77,51 0,99968800 25°07'08,24537"S 50°09'37,19149"W

60=PP 7.221.541,415 584.668,623 256°45'58" 160,62 0,99968804 25°07'10,69507"S 50°09'36,54362"W

ÁREA RESULTANTE = 16.927,39 m2 PERÍMETRO RESULTANTE = 569,79 m

ESTATÍSTICA:	ÁREA = 16.927,39 m2 PERÍMETRO = 569,79 m
OBRA:	PLANTA TOPOGRÁFICA
TÍTULO:	LEVANTAMENTO PLANALTIMÉTRICO ANTIGO SISTEMA GEODÉSICO BRASILEIRO UTM-SAD-69 - MC 51° W
PROP.:	TRIBUNAL DE JUSTIÇA DO ESTADO DO PARANÁ BAIRRO DE OFICINAS - PONTA GROSSA - PARANÁ
RESP. TÉCNICO:	FABIO MOREIRA RABELO - ENGENHEIRO CIVIL - CREA(RJ) 1994104196
DESENHO:	VALMR
DATA:	09/06/2020
ESCALA(S):	1:1000
FOLHA:	7





ENGENHARIA  
ARQUITETURA

OBRA:

**PROJETO DE CONSTRUÇÃO DO FÓRUM  
DA COMARCA DE PONTA GROSSA**

PROPRIETÁRIO:

**TRIBUNAL DE JUSTIÇA DO ESTADO DO  
PARANÁ**

ESPECIALIDADE:

**LEVANTAMENTO PLANIALTIMÉTRICO**

ASSUNTO:

**RELATÓRIO DE LEVANTAMENTO  
PLANIALTIMÉTRICO**

RESPONSÁVEL TÉCNICO:

**Eng. Fábio Rabelo  
1994104196 CREA/RJ**

CÓDIGO:

**PGR-1E-PLA-001-RELATORIO  
PLANIALTIMÉTRICO-2020-04-06\_R01**

REVISÃO	DESCRIÇÃO	RESPONSÁVEL	DATA
0	EMISSÃO INICIAL	FABIO	06/04/2020
1	REVISÃO 1	FABIO	10/06/2020





## IRAPLAN TOPOGRAFIA

Rua Engenheiro Teixeira Soares, 206 – CEP 84.040-180 - Vila Estrela – Ponta Grossa – PR.  
Fone (42) 3223-2929 – E-mail: iraplantopografia@gmail.com

# LAUDO TÉCNICO

Referente a serviços topográficos de um terreno urbano, localizado à Avenida Mestre Alberto Scarpin, na Vila Ferroviária, bairro de Oficinas, cidade de Ponta Grossa, estado do Paraná, pertencente ao Poder Judiciário, destinado à construção de nova sede do Tribunal de Justiça do Estado do Paraná.



Figura a: croqui de localização. Fonte Google Earth.

O trabalho foi solicitado pela empresa ENAR ENGENHARIA E ARQUITETURA LTDA., CNPJ 40.450.348/0001-03, Rio de Janeiro (RJ), conforme contrato de prestação de serviço datado de 02 de março de 2.020 (contrato em anexo).

Inicialmente se fez o transporte de coordenadas de dois pontos de apoio topográfico com a utilização de um par de receptores GPS, marca Leica, modelo SR-20, no sistema geodésico brasileiro UTM/SIRGAS2000. A coordenada desses pontos foi transformada para o sistema utm SAD-69 com a utilização do programa topográfico POSIÇÃO. Esses pontos serviram para o enquadramento das medições topográficas.

O levantamento topográfico foi realizado com a utilização de uma estação total robótica marca Leica, modelo TS-12 e controladora marca Leica, modelo CS-10.

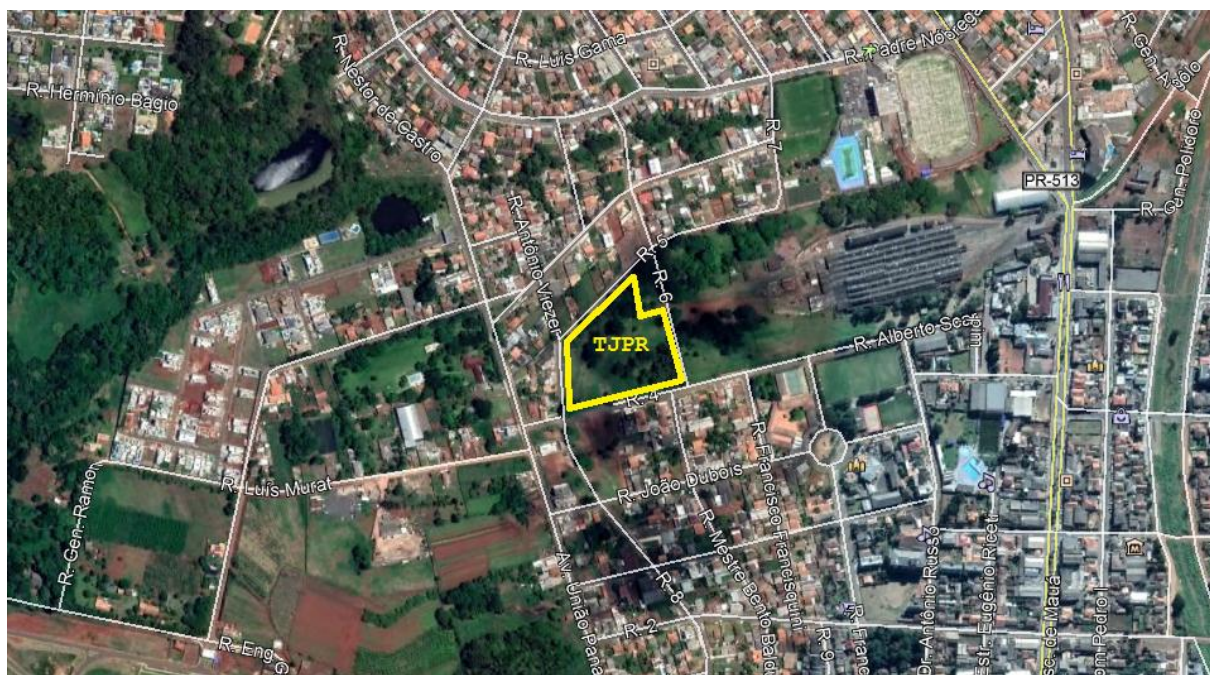
O primeiro elemento levantado foi o perímetro do terreno, materializado por alambrado, cuja área totalizou 16.927,39 m<sup>2</sup> e perímetro de 569,79 m.



A partir da determinação do perímetro foi amostrada uma malha regular 15x15 m na parte interna, proporcionando uma boa distribuição de pontos cotados visando a construção das curvas de nível.

Essa malha interna foi complementada com a amostragem de pontos de interesse ao projeto, como taludes, limites de capões de mato, árvores isoladas, monumento e pontos de sondagem geotécnica.

Externamente ao terreno foram amostradas as vias de trânsito, posteamento, bocas-de-lobo, bocas-de-leão, árvores isoladas e outros elementos de interesse ao projeto.

O trabalho foi apresentado em arquivo digital para AutoCAD, extensão DWG, que servirá de base para a elaboração de projeto.

Também foi entregue uma planta na escala 1:1000, com representação das curvas de nível com intervalo vertical de 0,5 metro e um arquivo digital na extensão PDF.

A amostragem totalizou 961 pontos topográficos, apresentados em relatório de coordenadas datado de 19 de março de 2.020. São apresentados todos os pontos no sistema UTM/SAD-69 (observação: os pontos de Z\_01 a Z\_16 são os pontos de apoio topográfico, materializados por parafusos “Philips” no eixo das vias).

IDENTIF.	NORTE	LESTE	COTA	DESCRIÇÃO
P001	7221576.6407	584682.1999	902.178	CERCA
P002	7221585.2117	584718.4759	902.909	CERCA
P004	7221559.0497	584561.8249	898.058	CERCA
P005	7221556.5207	584560.6729	898.093	CERCA
P006	7221553.9137	584560.3259	898.173	CERCA
P007	7221550.9517	584560.9889	898.324	CERCA
P008	7221548.3857	584561.8849	898.521	CERCA
P009	7221631.7507	584559.8009	895.889	CERCA
P010	7221649.4847	584565.5469	894.942	CERCA
P011	7221708.5177	584626.9349	893.513	CERCA
P012	7221710.4707	584628.7939	893.641	CERCA
P013	7221717.4197	584636.3529	893.526	CERCA
P014	7221652.9677	584667.5589	899.071	CERCA
P015	7221786.7967	584718.4479	891.148	CERCA
P016	7221785.9097	584716.1329	891.028	CERCA





IDENTIF.	NORTE	LESTE	COTA	DESCRIÇÃO
P017	7221784.5667	584713.7229	891.009	CERCA
P018	7221779.0137	584703.7599	891.072	CERCA
P019	7221767.7157	584692.6119	891.693	CERCA
P020	7221730.0677	584649.5129	892.781	CERCA
P021	7221718.3127	584617.0949	892.880	POSTE
P022	7221734.0467	584630.3749	892.155	LOTE
P023	7221745.9987	584642.3559	892.036	LOTE
P024	7221741.5297	584640.6039	892.012	POSTE
P025	7221760.0857	584659.4269	890.735	BOCALEAO
P026	7221759.4537	584660.0919	890.799	BOCALEAO
P027	7221760.7187	584661.1169	890.899	BOCALEAO
P028	7221761.2477	584660.4339	890.906	BOCALEAO
P029	7221760.1797	584660.0739	889.783	BOCALEAO
P030	7221766.7187	584665.9189	890.626	POSTE
P031	7221794.8477	584665.7939	887.676	POSTE
P032	7221808.3337	584659.2689	885.606	LOTE
P033	7221808.4757	584664.5459	885.621	BOCALEAO
P034	7221808.1267	584663.6189	885.597	BOCALEAO
P035	7221809.5517	584663.1799	885.694	BOCALEAO
P036	7221809.8687	584664.0089	885.680	BOCALEAO
P037	7221822.7557	584654.8009	884.198	LOTE
P038	7221830.3907	584654.2599	882.434	POSTE
P039	7221840.0727	584649.3539	880.747	ESQUINA
P040	7221853.0597	584661.7889	880.017	ESQUINA
P041	7221840.2927	584653.0259	880.840	BOCALOBO
P042	7221839.3567	584653.2979	880.967	BOCALOBO
P043	7221835.8887	584662.3729	882.313	BOCALOBO



IDENTIF.	NORTE	LESTE	COTA	DESCRIÇÃO
P044	7221835.0757	584662.6699	882.457	BOCALOBO
P045	7221835.4337	584663.8229	882.623	BOCALOBO
P046	7221836.2977	584663.5089	882.496	BOCALOBO
P047	7221837.3547	584666.8289	882.556	LOTE
P048	7221821.7567	584671.7319	884.375	LOTE
P049	7221791.7687	584670.2409	887.707	BOCALEAO
P050	7221791.5207	584669.6229	887.733	BOCALEAO
P051	7221790.5377	584669.7909	887.799	BOCALEAO
P052	7221790.8397	584670.6979	887.764	BOCALEAO
P053	7221790.9617	584678.9069	888.423	BOCALEAO
P054	7221791.1737	584679.4589	888.454	BOCALEAO
P055	7221790.2937	584679.7659	888.529	BOCALEAO
P056	7221790.1037	584679.2669	888.516	BOCALEAO
P057	7221787.4407	584682.5819	888.824	LOTE
P058	7221786.5047	584683.3289	888.935	LOTE
P059	7221786.3027	584684.5249	889.059	LOTE
P060	7221786.8187	584685.4989	889.145	LOTE
P061	7221796.8097	584698.6939	889.222	LOTE
P062	7221792.5047	584696.3019	889.452	POSTE
P063	7221802.8267	584713.5749	889.249	LOTE
P064	7221796.4937	584715.1439	890.260	MEIOFIO
P065	7221794.6727	584710.2599	890.251	MEIOFIO
P066	7221791.3037	584702.9489	890.147	MEIOFIO
P067	7221788.1037	584697.1149	890.144	MEIOFIO
P068	7221785.6127	584692.9399	890.123	MEIOFIO
P069	7221781.8517	584687.4169	890.040	MEIOFIO
P070	7221781.5697	584686.6489	889.999	MEIOFIO





IDENTIF.	NORTE	LESTE	COTA	DESCRIÇÃO
P071	7221783.1527	584682.8659	889.432	MEIOFIO
P072	7221783.6427	584682.1429	889.374	MEIOFIO
P073	7221786.3077	584680.2549	889.004	MEIOFIO
P074	7221792.9877	584677.8829	888.225	MEIOFIO
P075	7221800.4457	584675.2119	887.331	MEIOFIO
P076	7221808.0777	584672.4959	886.351	MEIOFIO
P077	7221815.7227	584669.8019	885.327	MEIOFIO
P078	7221820.3337	584668.1489	884.617	MEIOFIO
P079	7221827.5957	584665.5709	883.699	MEIOFIO
P080	7221834.9487	584662.9489	882.640	MEIOFIO
P081	7221842.9447	584660.0949	881.233	MEIOFIO
P082	7221847.7517	584658.4339	880.443	MEIOFIO
P083	7221851.3237	584657.6279	879.858	MEIOFIO
P084	7221854.3387	584658.5409	879.674	MEIOFIO
P085	7221855.9207	584661.0349	879.685	MEIOFIO
P086	7221862.7267	584658.9439	879.563	MEIOFIO
P087	7221861.3357	584655.9249	879.457	MEIOFIO
P088	7221861.6867	584654.3989	879.176	MEIOFIO
P089	7221863.1497	584653.4489	878.907	MEIOFIO
P090	7221862.6797	584657.2609	879.577	PVTELEF
P091	7221862.8337	584657.9529	879.572	PVTELEF
P092	7221863.2177	584657.4149	879.573	PVTELEF
P093	7221866.6797	584650.1129	878.145	PVSANEP
P094	7221866.9617	584649.6589	878.094	PVSANEP
P095	7221866.4477	584649.6119	878.148	PVSANEP
P096	7221844.5527	584650.3969	880.256	MEIOFIO
P097	7221840.6527	584652.5869	880.919	MEIOFIO



IDENTIF.	NORTE	LESTE	COTA	DESCRIÇÃO
P098	7221838.7157	584653.3189	881.243	MEIOFIO
P099	7221831.4197	584656.0199	882.433	MEIOFIO
P100	7221826.0827	584658.0699	883.380	MEIOFIO
P101	7221826.4007	584658.4119	883.139	VIAPAV
P102	7221827.6547	584661.7639	883.403	VIAPAV
P103	7221836.8117	584661.6559	882.159	VIAPAV
P104	7221835.7517	584659.0159	882.135	VIAPAV
P105	7221834.4347	584655.7419	881.897	VIAPAV
P106	7221846.2477	584651.0869	880.048	VIAPAV
P107	7221847.5227	584654.4699	880.132	VIAPAV
P108	7221848.4557	584657.5569	880.153	VIAPAV
P109	7221828.9827	584664.4509	883.351	VIAPAV
P110	7221820.8797	584667.2999	884.492	VIAPAV
P111	7221819.5297	584664.5849	884.545	VIAPAV
P112	7221818.3627	584661.2869	884.305	VIAPAV
P113	7221806.6957	584665.0449	885.856	VIAPAV
P114	7221807.4897	584668.7889	886.141	VIAPAV
P115	7221808.2537	584671.8889	886.190	VIAPAV
P116	7221798.4327	584675.1269	887.432	VIAPAV
P117	7221797.3857	584672.2099	887.402	VIAPAV
P118	7221796.1167	584668.6529	887.172	VIAPAV
P119	7221786.9127	584672.4029	888.262	VIAPAV
P120	7221787.7907	584675.9029	888.554	VIAPAV
P121	7221788.7227	584678.6669	888.597	VIAPAV
P122	7221783.1507	584681.7739	889.308	VIAPAV
P123	7221780.4187	584678.2939	889.476	VIAPAV
P124	7221780.8227	584674.4599	888.993	VIAPAV





IDENTIF.	NORTE	LESTE	COTA	DESCRIÇÃO
P125	7221777.5287	584674.6119	889.321	VIAPAV
P126	7221773.5297	584674.4009	889.904	VIAPAV
P127	7221770.2517	584672.5859	890.283	VIAPAV
P128	7221793.0467	584716.6399	890.379	VIAPAV
P129	7221789.4827	584717.5639	890.450	VIAPAV
P130	7221786.2947	584709.3409	890.424	VIAPAV
P131	7221789.3997	584707.8289	890.334	VIAPAV
P132	7221791.5307	584704.9839	890.147	VIAPAV
P133	7221796.0407	584715.6709	890.221	VIAPAV
P134	7221785.5017	584693.9459	890.066	VIAPAV
P135	7221782.7167	584695.3259	890.248	VIAPAV
P136	7221779.6737	584697.1429	890.368	VIAPAV
P137	7221775.8687	584691.8049	890.372	VIAPAV
P138	7221778.8567	584689.4669	890.246	VIAPAV
P139	7221781.0017	584687.5189	890.004	VIAPAV
P140	7221776.4677	584681.5809	890.069	VIAPAV
P141	7221774.0827	584683.1229	890.308	VIAPAV
P142	7221771.0177	584684.9069	890.489	VIAPAV
P143	7221763.4647	584675.4549	890.706	VIAPAV
P144	7221766.4417	584673.6149	890.614	VIAPAV
P145	7221764.1997	584680.5689	890.647	VIAPAV
P146	7221769.6327	584689.5569	890.526	VIAPAV
P147	7221760.9887	584676.8709	890.952	POSTE
P148	7221757.2617	584668.5549	891.026	VIAPAV
P149	7221759.6737	584666.3169	890.962	VIAPAV
P150	7221762.4857	584664.0649	890.770	VIAPAV
P151	7221755.1877	584666.4469	891.098	BOCALEAO



IDENTIF.	NORTE	LESTE	COTA	DESCRIÇÃO
P152	7221754.5417	584667.0279	891.180	BOCALEAO
P153	7221753.4117	584665.9749	891.061	BOCALEAO
P154	7221754.0817	584665.3839	891.090	BOCALEAO
P155	7221749.4807	584660.4769	891.300	VIAPAV
P156	7221752.0577	584658.2699	891.282	VIAPAV
P157	7221754.6517	584655.9379	891.143	VIAPAV
P158	7221748.0347	584649.1069	891.449	VIAPAV
P159	7221745.3297	584651.5069	891.587	VIAPAV
P160	7221742.8707	584653.8849	891.572	VIAPAV
P161	7221736.5767	584647.4569	891.865	VIAPAV
P162	7221739.1377	584645.2679	891.885	VIAPAV
P163	7221742.0047	584643.8359	891.757	VIAPAV
P164	7221735.8607	584637.7159	892.056	VIAPAV
P165	7221733.8477	584639.7979	892.149	VIAPAV
P166	7221731.2537	584642.2089	892.138	VIAPAV
P167	7221724.8817	584635.8329	892.454	VIAPAV
P168	7221727.3487	584633.5459	892.468	VIAPAV
P169	7221730.0637	584631.3679	892.318	VIAPAV
P170	7221723.5847	584624.8139	892.626	VIAPAV
P171	7221721.1347	584627.1929	892.748	VIAPAV
P172	7221718.6937	584629.6499	892.728	VIAPAV
P173	7221712.5787	584623.4879	892.969	VIAPAV
P174	7221717.4417	584618.6879	892.882	VIAPAV
P175	7221711.7877	584613.4019	893.097	VIAPAV
P176	7221709.5547	584615.6839	893.172	VIAPAV
P177	7221707.3707	584618.1469	893.157	VIAPAV
P178	7221701.1397	584611.9589	893.336	VIAPAV



IDENTIF.	NORTE	LESTE	COTA	DESCRIÇÃO
P179	7221703.2897	584609.5649	893.363	VIAPAV
P180	7221705.7797	584607.3149	893.267	VIAPAV
P181	7221735.6937	584654.1009	892.548	PTOCOTA
P182	7221742.1027	584661.9859	892.818	PTOCOTA
P183	7221749.4727	584670.1719	892.222	PTOCOTA
P184	7221756.4517	584680.4339	892.257	PTOCOTA
P185	7221755.2587	584683.7579	892.342	PTOCOTA
P186	7221740.5117	584685.8249	893.247	PTOCOTA
P187	7221729.4387	584686.7459	894.559	PTOCOTA
P188	7221715.5147	584688.4689	895.901	PTOCOTA
P189	7221704.4497	584692.6909	897.065	PTOCOTA
P190	7221717.2417	584694.9799	895.093	VIANPAV
P191	7221721.5287	584700.3369	894.580	VIANPAV
P192	7221718.1087	584698.2209	895.121	VIANPAV
P193	7221714.7757	584704.9109	896.100	CERCA
P194	7221738.4297	584699.3139	894.095	CERCA
P195	7221739.5197	584696.1459	892.754	VIANPAV
P196	7221741.5977	584692.7419	892.716	VIANPAV
P197	7221741.7347	584689.2909	892.420	VIANPAV
P198	7221754.9327	584685.7039	891.476	VIANPAV
P199	7221755.7887	584689.6879	891.469	VIANPAV
P200	7221756.5427	584692.8729	891.470	VIANPAV
P201	7221758.8747	584694.6869	892.615	CERCA
P202	7221766.3377	584690.5769	890.651	VIANPAV
P203	7221763.2517	584687.4019	890.875	VIANPAV
P204	7221760.5077	584684.3179	890.928	VIANPAV
P205	7221757.7167	584686.1019	891.238	BOCALEAO





IDENTIF.	NORTE	LESTE	COTA	DESCRIÇÃO
P206	7221757.5607	584684.9949	891.325	BOCALEAO
P207	7221756.3637	584685.3249	891.460	BOCALEAO
P208	7221756.4457	584686.2989	891.387	BOCALEAO
P209	7221711.8677	584653.9269	894.543	CERCA
P210	7221700.3307	584656.6669	895.164	CERCA
P211	7221675.1077	584569.8519	893.313	LOTE
P212	7221681.2757	584580.8139	893.738	LEUCENA
P213	7221681.4267	584581.2679	893.783	LEUCENA
P214	7221681.6937	584580.8939	893.675	LEUCENA
P215	7221686.9027	584582.1049	893.246	LOTE
P216	7221702.6917	584603.3309	893.192	BOCALEAO
P217	7221703.3027	584602.7899	893.133	BOCALEAO
P218	7221704.3577	584603.8109	893.182	BOCALEAO
P219	7221703.7687	584604.4319	893.359	BOCALEAO
P220	7221694.5037	584592.9849	893.538	POSTE
P221	7221710.2267	584606.2029	892.775	LOTE
P222	7221721.9357	584618.2719	892.572	LOTE
P224	7221701.4287	584602.6829	893.346	VIAPAV
P225	7221698.8707	584605.1469	893.483	VIAPAV
P226	7221696.4597	584607.4039	893.448	VIAPAV
P227	7221697.7267	584609.0379	893.142	BOCALEAO
P228	7221697.1297	584609.5439	893.232	BOCALEAO
P229	7221698.7617	584609.8059	893.316	BOCALEAO
P230	7221698.1677	584610.4569	893.232	BOCALEAO
P231	7221688.3767	584599.4569	893.711	VIAPAV
P232	7221693.1937	584594.7869	893.609	VIAPAV
P233	7221685.7547	584587.4189	893.781	VIAPAV



IDENTIF.	NORTE	LESTE	COTA	DESCRIÇÃO
P234	7221683.5777	584590.0249	893.890	VIAPAV
P235	7221681.0517	584592.3739	893.882	VIAPAV
P236	7221674.8717	584586.2469	894.043	VIAPAV
P237	7221677.1167	584583.7409	894.008	VIAPAV
P238	7221679.6167	584581.3809	893.881	VIAPAV
P239	7221673.2137	584575.2209	893.985	VIAPAV
P240	7221670.7207	584577.5929	894.143	VIAPAV
P241	7221668.3817	584579.9569	894.185	VIAPAV
P242	7221663.1167	584575.0189	894.310	VIAPAV
P243	7221667.5637	584569.8869	894.158	VIAPAV
P244	7221669.7207	584567.7999	893.889	POSTE
P245	7221661.3187	584564.0679	894.389	VIAPAV
P246	7221658.9027	584566.2809	894.515	VIAPAV
P247	7221656.5047	584568.7929	894.523	VIAPAV
P248	7221651.2047	584564.0709	894.714	VIAPAV
P249	7221653.6977	584561.4459	894.688	VIAPAV
P250	7221655.6837	584559.1649	894.598	VIAPAV
P251	7221658.1937	584574.5719	894.577	CERCA
P252	7221666.8117	584583.5599	894.425	CERCA
P253	7221675.5307	584592.6059	894.243	CERCA
P254	7221684.2177	584601.6749	894.116	CERCA
P255	7221692.9297	584610.7149	894.075	CERCA
P256	7221701.6107	584619.7769	893.879	CERCA
P257	7221653.4827	584557.1719	894.674	VIAPAV
P258	7221653.3397	584554.8759	894.549	VIAPAV
P259	7221654.6417	584552.3939	894.152	VIAPAV
P260	7221656.9427	584551.2059	893.834	MEIOFIO





IDENTIF.	NORTE	LESTE	COTA	DESCRIÇÃO
P261	7221656.5937	584550.1769	893.717	VIAPAV
P262	7221655.8897	584547.8099	893.674	VIAPAV
P263	7221654.9067	584545.3759	893.571	VIAPAV
P264	7221654.8197	584544.5339	893.603	MEIOFIO
P265	7221660.8197	584543.0929	892.685	BOCALOBO
P266	7221660.5567	584542.2249	892.672	BOCALOBO
P267	7221659.6837	584542.4769	892.810	BOCALOBO
P268	7221668.0367	584540.5499	892.045	MEIOFIO
P269	7221668.2657	584541.6369	892.081	VIAPAV
P270	7221669.6487	584546.6889	892.128	VIAPAV
P271	7221669.9587	584547.2539	892.195	MEIOFIO
P272	7221671.4177	584549.7189	891.891	POSTE
P273	7221686.3727	584542.2829	891.112	POSTE
P274	7221685.9137	584541.5339	891.055	VIAPAV
P275	7221685.0657	584539.0359	891.121	VIAPAV
P276	7221684.0747	584536.4759	891.123	VIAPAV
P277	7221683.8987	584535.7079	891.152	MEIOFIO
P278	7221692.3557	584533.1389	890.578	MEIOFIO
P279	7221692.4807	584533.9579	890.494	VIAPAV
P280	7221693.1927	584536.5529	890.498	VIAPAV
P281	7221693.8327	584539.2469	890.439	VIAPAV
P282	7221694.0237	584539.9659	890.520	MEIOFIO
P283	7221702.2867	584537.4949	889.806	MEIOFIO
P284	7221701.9297	584536.7409	889.747	VIAPAV
P285	7221701.0817	584534.2109	889.817	VIAPAV
P286	7221699.8917	584531.6389	889.867	VIAPAV
P287	7221699.6397	584530.9399	889.971	MEIOFIO



IDENTIF.	NORTE	LESTE	COTA	DESCRIÇÃO
P288	7221713.6687	584526.7149	888.586	MEIOFIO
P289	7221713.8807	584527.6659	888.506	VIAPAV
P290	7221713.8647	584530.4069	888.586	VIAPAV
P291	7221714.5997	584533.1089	888.593	VIAPAV
P292	7221714.7457	584533.7039	888.684	MEIOFIO
P293	7221709.0357	584537.8209	888.750	POSTE
P294	7221708.4787	584540.6489	887.989	LOTE
P295	7221728.9667	584534.2809	887.144	ESQUINA
P296	7221727.8737	584529.7839	887.367	MEIOFIO
P297	7221731.0407	584529.7859	887.213	MEIOFIO
P298	7221732.1407	584530.2359	887.182	MEIOFIO
P299	7221733.0087	584530.9129	887.030	MEIOFIO
P300	7221734.8187	584532.6829	886.894	MEIOFIO
P301	7221743.4877	584529.9409	886.608	MEIOFIO
P302	7221742.2047	584528.6889	886.638	MEIOFIO
P303	7221741.7907	584526.4789	886.434	MEIOFIO
P304	7221743.7397	584524.0409	886.053	MEIOFIO
P305	7221745.8577	584527.3959	886.429	ESQUINA
P306	7221743.9637	584527.9819	886.494	PVTELEF
P307	7221743.5377	584528.4369	886.474	PVTELEF
P308	7221743.2947	584527.8929	886.495	PVTELEF
P309	7221730.1817	584528.4219	887.208	VIAPAV
P310	7221727.9387	584526.2619	887.361	VIAPAV
P311	7221725.0837	584523.5299	887.438	VIAPAV
P312	7221721.1597	584521.2639	887.707	PVSANEP
P313	7221719.3147	584519.9579	887.836	ESQUINA
P314	7221721.4107	584519.4419	887.409	MEIOFIO





IDENTIF.	NORTE	LESTE	COTA	DESCRIÇÃO
P315	7221721.6047	584523.6209	887.741	MEIOFIO
P316	7221720.4887	584524.6699	887.885	MEIOFIO
P317	7221715.4817	584525.5239	888.333	BOCALOBO
P318	7221714.6147	584525.8119	888.438	BOCALOBO
P319	7221714.9567	584526.8339	888.376	BOCALOBO
P320	7221715.8077	584526.6159	888.276	BOCALOBO
P321	7221718.7297	584532.0589	888.226	BOCALOBO
P322	7221717.9007	584532.3889	888.294	BOCALOBO
P323	7221718.2177	584533.4509	888.211	BOCALOBO
P324	7221719.0507	584533.2069	888.189	BOCALOBO
P325	7221700.2357	584526.1699	890.773	LOTE
P326	7221684.8897	584531.4609	891.309	LOTE
P327	7221668.7277	584536.4729	891.715	LOTE
P328	7221667.5967	584535.3159	891.738	LOTE
P329	7221659.5207	584538.6099	891.989	LOTE
P330	7221651.8497	584541.8159	893.997	LOTE
P331	7221650.3457	584540.3799	894.133	LOTE
P332	7221647.8007	584543.0459	894.546	LOTE
P333	7221647.1927	584544.8149	894.797	POSTE
P334	7221653.4257	584543.4409	893.688	CINAMOMO
P335	7221654.0727	584543.4449	893.520	CINAMOMO
P336	7221653.8397	584543.9939	893.791	CINAMOMO
P337	7221654.0387	584544.8199	893.702	MEIOFIO
P338	7221653.2447	584543.1969	893.594	MEIOFIO
P339	7221648.0967	584545.0709	894.582	MEIOFIO
P340	7221644.6747	584545.1719	894.971	MEIOFIO
P341	7221640.2247	584545.3819	895.116	MEIOFIO



IDENTIF.	NORTE	LESTE	COTA	DESCRIÇÃO
P342	7221634.8967	584545.6019	895.162	MEIOFIO
P343	7221628.1637	584545.8639	895.249	MEIOFIO
P344	7221628.1517	584543.9449	895.248	LOTE
P345	7221628.1827	584546.9649	895.261	VIAPAV
P346	7221628.3207	584550.5589	895.482	VIAPAV
P347	7221630.6797	584553.9059	895.349	VIAPAV
P348	7221631.7377	584556.3329	895.583	POSTE
P349	7221634.8627	584554.5039	895.238	VIAPAV
P350	7221641.9437	584557.5879	894.981	VIAPAV
P351	7221647.7587	584560.8989	894.777	VIAPAV
P352	7221640.8527	584562.7069	895.523	CERCA
P353	7221648.4437	584552.4289	894.806	VIAPAV
P354	7221647.0937	584550.4739	894.851	VIAPAV
P355	7221645.5057	584546.3059	894.813	VIAPAV
P356	7221645.9607	584546.1699	894.824	PVSANEP
P357	7221646.2547	584546.5979	894.796	PVSANEP
P358	7221646.4877	584546.1449	894.787	PVSANEP
P359	7221639.4047	584546.5469	895.045	VIAPAV
P360	7221632.3087	584546.7789	895.153	VIAPAV
P361	7221628.1747	584546.7859	895.298	MEIOFIO
P362	7221622.2187	584547.0449	895.679	MEIOFIO
P363	7221621.8317	584547.3919	895.663	BOCALOBO
P364	7221620.8737	584547.4819	895.723	BOCALOBO
P365	7221620.7347	584546.2349	895.873	BOCALOBO
P366	7221621.7707	584546.1729	895.787	BOCALOBO
P367	7221617.1287	584544.2829	896.293	LOTE
P368	7221620.3517	584547.1699	895.778	MEIOFIO





IDENTIF.	NORTE	LESTE	COTA	DESCRIÇÃO
P369	7221611.6007	584547.6179	896.191	MEIOFIO
P370	7221609.9747	584544.4999	896.525	LOTE
P371	7221611.9137	584548.3169	896.169	VIAPAV
P372	7221612.2477	584551.2359	896.257	VIAPAV
P373	7221612.3297	584554.7879	896.230	VIAPAV
P374	7221602.8687	584555.2279	896.631	VIAPAV
P375	7221603.0317	584551.7679	896.689	VIAPAV
P376	7221603.0007	584548.6189	896.576	VIAPAV
P377	7221602.0897	584548.1289	896.640	MEIOFIO
P378	7221602.3057	584544.7599	896.746	LOTE
P379	7221590.1997	584545.1129	897.160	LOTE
P380	7221590.2987	584548.6809	897.103	MEIOFIO
P381	7221590.2817	584549.3519	897.098	VIAPAV
P382	7221590.3987	584552.2859	897.193	VIAPAV
P383	7221590.6637	584555.7769	897.145	VIAPAV
P384	7221594.3077	584557.6859	897.412	POSTE
P385	7221582.3047	584556.0819	897.429	VIAPAV
P386	7221582.2997	584552.7559	897.487	VIAPAV
P387	7221582.4137	584549.7429	897.398	VIAPAV
P388	7221578.1507	584549.2059	897.550	MEIOFIO
P389	7221577.8027	584545.4899	897.582	LOTE
P390	7221570.3397	584548.8889	897.884	ARVORE
P391	7221571.0487	584548.7379	897.852	ARVORE
P392	7221570.4517	584547.8389	897.859	ARVORE
P393	7221567.5667	584549.7339	897.929	MEIOFIO
P394	7221567.6727	584550.4929	897.882	VIAPAV
P395	7221567.8867	584553.4079	897.928	VIAPAV



IDENTIF.	NORTE	LESTE	COTA	DESCRIÇÃO
P396	7221568.0937	584556.6619	897.843	VIAPAV
P397	7221568.9147	584561.5709	898.096	CERCA
P398	7221581.3697	584561.2159	897.899	CERCA
P399	7221593.8797	584560.8479	897.490	CERCA
P400	7221616.1427	584560.2289	896.624	CERCA
P401	7221623.9597	584559.9799	896.271	CERCA
P402	7221589.7517	584738.2539	903.322	CERCA
P403	7221596.0537	584733.5449	903.093	CERCA
P404	7221598.4397	584731.8649	902.873	CERCA
P405	7221609.3917	584729.1109	902.692	CERCA
P406	7221621.2767	584726.5349	902.097	CERCA
P407	7221634.2407	584723.4399	901.507	CERCA
P408	7221646.8067	584720.4049	900.770	CERCA
P409	7221654.1547	584718.6889	900.575	CERCA
P410	7221653.9127	584718.4809	900.711	EUCALIPT [ [ [
P411	7221652.7437	584718.3999	900.744	EUCALIPT [ [ [
P412	7221652.8047	584717.5899	900.683	EUCALIPT [ [ [
P413	7221656.2147	584718.1579	900.396	EUCALIPT [ [ [
P414	7221656.1557	584717.6569	900.522	EUCALIPT [ [ [
P415	7221677.3867	584699.3219	898.868	EUCALIPT [ [ [
P416	7221677.2057	584699.9449	898.935	EUCALIPT [ [ [
P417	7221677.9907	584700.0929	898.742	EUCALIPT [ [ [
P418	7221700.7757	584699.0809	897.743	VIANPAV
P419	7221700.9957	584701.5529	897.759	VIANPAV
P420	7221701.9887	584704.0679	897.775	VIANPAV
P421	7221697.7877	584705.0029	898.434	TRILHO
P422	7221696.5457	584699.8809	898.452	TRILHO





IDENTIF.	NORTE	LESTE	COTA	DESCRIÇÃO
P423	7221695.6997	584701.2709	898.447	TRILHO
P424	7221692.2417	584700.4769	898.482	VIANPAV
P425	7221692.8307	584703.8139	898.548	VIANPAV
P426	7221692.9797	584706.5339	898.539	VIANPAV
P427	7221683.2747	584709.2789	898.649	VIANPAV
P428	7221682.4407	584706.2479	898.679	VIANPAV
P429	7221681.3667	584703.1179	898.604	VIANPAV
P430	7221672.1887	584705.2559	898.905	VIANPAV
P431	7221672.2457	584708.0489	898.993	VIANPAV
P432	7221672.4007	584712.0209	899.003	VIANPAV
P433	7221663.2857	584712.9049	899.508	VIANPAV
P434	7221662.5687	584710.3579	899.441	VIANPAV
P435	7221661.5507	584707.4899	899.314	VIANPAV
P436	7221651.7977	584710.3559	899.878	VIANPAV
P437	7221652.0767	584713.0569	900.104	VIANPAV
P438	7221652.3007	584715.6429	900.098	VIANPAV
P439	7221642.9617	584718.1579	900.438	VIANPAV
P440	7221642.4347	584715.4639	900.428	VIANPAV
P441	7221641.4347	584712.7969	900.263	VIANPAV
P442	7221632.4167	584715.1329	900.561	VIANPAV
P443	7221632.7777	584717.8369	900.790	VIANPAV
P444	7221633.2737	584720.6729	900.801	VIANPAV
P445	7221623.9287	584722.8749	901.187	VIANPAV
P446	7221623.3147	584720.3689	901.169	VIANPAV
P447	7221622.5747	584717.9589	900.986	VIANPAV
P448	7221613.3067	584720.0909	901.432	VIANPAV
P449	7221613.7117	584722.7039	901.562	VIANPAV



IDENTIF.	NORTE	LESTE	COTA	DESCRIÇÃO
P450	7221614.2417	584725.2659	901.565	VIANPAV
P451	7221604.6407	584727.6189	901.805	VIANPAV
P452	7221604.0607	584725.2189	901.911	VIANPAV
P453	7221603.5557	584722.5719	901.851	VIANPAV
P454	7221594.7177	584724.1979	902.217	VIANPAV
P455	7221594.8137	584726.8949	902.353	VIANPAV
P456	7221595.2737	584730.2959	902.274	VIANPAV
P457	7221588.1657	584732.7459	902.932	VIAPAV
P458	7221587.7197	584728.8999	902.917	VIAPAV
P459	7221585.5407	584724.5219	902.854	VIAPAV
P460	7221597.4727	584715.6799	902.648	CERCA
P461	7221610.3987	584712.6329	901.815	CERCA
P462	7221621.7597	584709.9839	901.533	CERCA
P463	7221636.3957	584706.5329	900.818	CERCA
P464	7221646.0647	584704.2829	900.388	CERCA
P465	7221660.6787	584700.8009	899.764	CERCA
P466	7221635.8167	584706.6619	900.831	CAPAO
P467	7221623.5177	584713.8579	901.371	CAPAO
P468	7221619.0557	584715.3029	901.667	CAPAO
P469	7221608.9737	584718.8009	902.119	CAPAO
P470	7221595.6067	584721.0839	903.135	CAPAO
P471	7221592.5547	584716.8319	902.815	CAPAO
P472	7221583.5207	584724.1739	903.019	VIAPAV
P473	7221581.6437	584723.1929	903.153	VIAPAV
P474	7221580.6127	584722.1759	903.165	VIAPAV
P475	7221579.2327	584717.1719	903.117	VIAPAV
P476	7221578.1557	584712.5809	903.054	VIAPAV



IDENTIF.	NORTE	LESTE	COTA	DESCRIÇÃO
P477	7221582.8677	584711.6079	902.955	POSTE
P478	7221575.0097	584713.6919	903.199	VIAPAV
P479	7221571.6427	584714.9079	903.266	VIAPAV
P480	7221573.9327	584722.9559	903.369	VIAPAV
P481	7221576.9897	584722.3969	903.322	VIAPAV
P482	7221575.8657	584731.3859	903.439	VIAPAV
P483	7221582.3547	584730.0769	903.316	VIAPAV
P484	7221585.8317	584734.7889	903.153	VIAPAV
P485	7221584.1607	584737.7319	903.406	VIAPAV
P486	7221585.4307	584742.6789	903.471	VIAPAV
P487	7221581.8837	584743.2289	903.635	VIAPAV
P488	7221578.9717	584743.8329	903.646	VIAPAV
P489	7221575.8707	584744.5669	903.914	POSTE
P490	7221578.2517	584743.9929	903.757	MEIOFIO
P491	7221576.5637	584736.6229	903.621	MEIOFIO
P492	7221574.7087	584728.8549	903.524	MEIOFIO
P493	7221572.7737	584720.5859	903.451	MEIOFIO
P494	7221571.6547	584717.4319	903.436	MEIOFIO
P495	7221570.3287	584715.0669	903.344	MEIOFIO
P496	7221569.0817	584713.9529	903.328	MEIOFIO
P497	7221567.4917	584713.6189	903.308	MEIOFIO
P498	7221565.8017	584713.6069	903.307	MEIOFIO
P499	7221568.0697	584714.5359	903.361	PVSANEP
P500	7221568.3437	584714.9799	903.381	PVSANEP
P501	7221568.5897	584714.5069	903.373	PVSANEP
P502	7221569.9967	584718.8399	903.437	EXTREMOS [ [ [
P503	7221571.7297	584726.5289	903.618	EXTREMOS [ [ [





IDENTIF.	NORTE	LESTE	COTA	DESCRIÇÃO
P504	7221572.9827	584732.3759	903.751	EXTREMOS [ [ [
P505	7221572.8737	584737.4469	903.916	LOTE
P506	7221587.4937	584751.5379	903.652	VIAPAV
P507	7221584.0087	584752.2299	903.813	VIAPAV
P508	7221580.9917	584752.9639	903.821	VIAPAV
P509	7221582.9647	584761.1929	903.977	VIAPAV
P510	7221585.8617	584760.3829	903.958	VIAPAV
P511	7221589.3667	584759.7329	903.855	VIAPAV
P512	7221591.1627	584767.4019	904.035	VIAPAV
P513	7221587.7447	584767.8479	904.099	VIAPAV
P514	7221584.7147	584768.5379	904.085	VIAPAV
P515	7221587.4067	584779.8439	904.265	VIAPAV
P516	7221590.4717	584779.3959	904.307	VIAPAV
P517	7221593.8137	584778.4899	904.239	VIAPAV
P518	7221595.6027	584785.8579	904.372	VIAPAV
P519	7221592.1467	584786.5759	904.456	VIAPAV
P520	7221588.7127	584787.2389	904.402	VIAPAV
P521	7221590.6207	584795.1689	904.566	VIAPAV
P522	7221593.9987	584794.4809	904.626	VIAPAV
P523	7221597.3957	584793.5839	904.550	VIAPAV
P524	7221599.2807	584801.5299	904.733	VIAPAV
P525	7221595.8197	584802.1189	904.790	VIAPAV
P526	7221592.4087	584802.8039	904.751	VIAPAV
P527	7221593.7327	584808.6369	904.936	VIAPAV
P528	7221597.2617	584807.7779	904.940	VIAPAV
P529	7221600.6087	584806.8519	904.844	VIAPAV
P530	7221590.2577	584808.6899	904.895	PVSANEP



IDENTIF.	NORTE	LESTE	COTA	DESCRIÇÃO
P531	7221590.3867	584808.1069	904.895	PVSANEP
P532	7221589.8597	584808.2689	904.908	PVSANEP
P533	7221589.1387	584807.4609	904.878	LOTE
P534	7221589.5187	584809.7799	904.904	MEIOFIO
P535	7221591.2567	584809.0549	904.926	MEIOFIO
P536	7221592.2947	584807.6909	904.998	MEIOFIO
P537	7221592.8347	584806.4439	904.829	MEIOFIO
P538	7221590.9677	584806.8829	904.840	MEIOFIO
P539	7221588.5267	584796.0139	904.643	MEIOFIO
P540	7221585.8457	584792.9669	904.915	LOTE
P541	7221586.6157	584787.0949	904.532	MEIOFIO
P542	7221585.4387	584784.1309	904.555	POSTE
P543	7221583.0117	584780.8119	904.535	LOTE
P544	7221585.1237	584780.3949	904.441	MEIOFIO
P545	7221586.7837	584780.0339	904.301	MEIOFIO
P546	7221583.9027	584767.8619	904.191	MEIOFIO
P547	7221580.2267	584769.0019	904.582	LOTE
P548	7221577.4337	584757.0679	904.381	LOTE
P549	7221581.1587	584756.1679	904.002	MEIOFIO
P550	7221579.1807	584747.6819	903.829	MEIOFIO
P551	7221567.9247	584716.8299	903.401	LOTE
P552	7221557.8527	584715.4909	903.347	MEIOFIO
P553	7221557.6937	584714.8049	903.237	VIAPAV
P554	7221556.8637	584711.0329	903.327	VIAPAV
P555	7221555.9637	584706.7459	903.073	VIAPAV
P556	7221552.4917	584706.7399	903.293	MEIOFIO
P557	7221551.9887	584704.3759	903.318	LOTE



IDENTIF.	NORTE	LESTE	COTA	DESCRIÇÃO
P558	7221564.1847	584701.5309	903.226	LOTE
P559	7221566.1517	584701.9539	902.894	PVSANEP
P560	7221566.6317	584702.1419	902.918	PVSANEP
P561	7221566.5487	584701.6189	902.888	PVSANEP
P562	7221565.4087	584699.9539	902.708	POSTE
P563	7221567.6947	584699.6989	902.858	MEIOFIO
P564	7221567.4997	584702.1529	902.971	MEIOFIO
P565	7221566.1747	584703.6139	903.125	MEIOFIO
P566	7221566.6807	584704.6419	902.970	VIAPAV
P567	7221567.5817	584708.5549	903.141	VIAPAV
P568	7221568.1257	584712.6729	903.196	VIAPAV
P569	7221565.0657	584715.8269	903.364	CEDRO
P570	7221559.6587	584717.1499	903.439	CEDRO
P571	7221558.2457	584717.5529	903.461	POSTE
P572	7221543.4967	584722.7339	903.640	LOTE
P573	7221542.3467	584719.2489	903.451	MEIOFIO
P574	7221542.2577	584718.5399	903.372	VIAPAV
P575	7221541.1397	584714.8339	903.441	VIAPAV
P576	7221540.3337	584710.2289	903.248	VIAPAV
P577	7221543.3677	584706.3739	903.354	LOTE
P578	7221532.0087	584709.0349	903.423	LOTE
P579	7221532.5297	584711.3539	903.427	MEIOFIO
P580	7221530.3417	584722.1249	903.472	MEIOFIO
P581	7221531.2777	584725.6009	903.825	LOTE
P582	7221530.2667	584721.3979	903.452	VIAPAV
P583	7221529.2777	584717.6669	903.549	VIAPAV
P584	7221528.0737	584713.2569	903.367	VIAPAV





IDENTIF.	NORTE	LESTE	COTA	DESCRIÇÃO
P585	7221516.5757	584712.8149	903.664	LOTE
P586	7221517.1287	584715.2129	903.652	MEIOFIO
P587	7221518.4957	584725.0459	903.620	MEIOFIO
P588	7221518.6547	584727.0519	903.583	POSTE
P589	7221519.4747	584728.3369	903.876	LOTE
P590	7221507.5267	584731.0679	903.843	LOTE
P591	7221506.6557	584727.9069	903.723	MEIOFIO
P592	7221506.5137	584727.2119	903.608	VIAPAV
P593	7221505.5367	584723.1599	903.724	VIAPAV
P594	7221504.5717	584718.9179	903.581	VIAPAV
P595	7221501.2277	584716.4539	903.702	LOTE
P596	7221501.7087	584718.7839	903.722	MEIOFIO
P597	7221494.6897	584730.8539	903.839	MEIOFIO
P598	7221495.4057	584733.8219	903.899	LOTE
P599	7221483.4617	584736.7049	904.267	LOTE
P600	7221482.5497	584733.8619	903.858	MEIOFIO
P601	7221482.3687	584732.9739	903.655	VIAPAV
P602	7221481.4917	584728.3649	903.767	VIAPAV
P603	7221480.6317	584724.4609	903.632	VIAPAV
P604	7221485.8107	584719.9329	903.732	LOTE
P605	7221453.9107	584727.4679	903.357	ESQUINA
P606	7221457.6387	584742.8879	904.022	ESQUINA
P607	7221572.4037	584702.9849	902.948	VIAPAV
P608	7221575.6407	584702.3629	902.837	VIAPAV
P609	7221573.7677	584694.4029	902.591	VIAPAV
P610	7221570.5537	584695.0409	902.682	VIAPAV
P611	7221567.3577	584695.7459	902.608	VIAPAV



IDENTIF.	NORTE	LESTE	COTA	DESCRIÇÃO
P612	7221565.4957	584687.3179	902.322	VIAPAV
P613	7221568.5797	584686.9359	902.398	VIAPAV
P614	7221571.9237	584686.3919	902.320	VIAPAV
P615	7221570.0407	584677.8849	902.031	VIAPAV
P616	7221566.6017	584678.5129	902.113	VIAPAV
P617	7221563.5217	584679.1859	902.043	VIAPAV
P618	7221561.5407	584670.7529	901.829	VIAPAV
P619	7221564.6307	584670.2099	901.865	VIAPAV
P620	7221568.0377	584669.5749	901.767	VIAPAV
P621	7221566.0177	584661.0219	901.512	VIAPAV
P622	7221559.5567	584662.4029	901.627	VIAPAV
P623	7221557.7767	584654.1499	901.441	VIAPAV
P624	7221560.7637	584653.7059	901.439	VIAPAV
P625	7221564.0787	584653.0589	901.346	VIAPAV
P626	7221562.0717	584644.2119	901.146	VIAPAV
P627	7221558.6897	584644.8919	901.229	VIAPAV
P628	7221555.5397	584645.5999	901.221	VIAPAV
P629	7221554.6967	584643.3499	901.143	VIAPAV
P630	7221552.8777	584635.5299	900.921	VIAPAV
P631	7221556.3237	584634.9639	900.964	VIAPAV
P632	7221559.5507	584633.3859	900.867	VIAPAV
P633	7221556.9517	584622.6319	900.607	VIAPAV
P634	7221553.5797	584623.3719	900.693	VIAPAV
P635	7221550.1707	584623.9389	900.669	VIAPAV
P636	7221549.3287	584622.3139	900.550	VIANPAV
P637	7221553.2197	584621.7969	900.680	VIANPAV
P638	7221557.1587	584620.9139	900.544	VIANPAV



IDENTIF.	NORTE	LESTE	COTA	DESCRIÇÃO
P639	7221555.1677	584612.6199	900.278	VIANPAV
P640	7221551.1987	584612.9989	900.422	VIANPAV
P641	7221547.9467	584613.7359	900.423	VIANPAV
P642	7221545.8927	584605.1189	900.121	VIANPAV
P643	7221549.4017	584604.4519	900.155	VIANPAV
P644	7221553.2517	584603.8229	900.012	VIANPAV
P645	7221550.7607	584595.1439	899.701	VIANPAV
P646	7221547.4127	584595.5179	899.830	VIANPAV
P647	7221543.5927	584596.6459	899.711	VIANPAV
P648	7221541.6847	584588.1639	899.449	VIANPAV
P649	7221545.4317	584587.1989	899.590	VIANPAV
P650	7221549.0307	584586.4329	899.402	VIANPAV
P651	7221547.0707	584578.3739	899.099	VIANPAV
P652	7221543.3637	584579.2449	899.340	VIANPAV
P653	7221539.7677	584579.8979	899.136	VIANPAV
P654	7221537.6387	584569.7509	898.787	VIANPAV
P655	7221541.3737	584569.3599	898.922	VIANPAV
P656	7221545.6057	584569.1349	898.752	VIANPAV
P657	7221534.5717	584565.4509	898.902	POSTE
P658	7221545.4997	584613.0539	900.341	PVSANEP
P659	7221544.6127	584613.1749	900.354	PVSANEP
P660	7221545.2137	584613.9129	900.393	PVSANEP
P661	7221543.1537	584621.0649	900.598	LOTE
P662	7221544.6707	584620.8569	900.535	LOTE
P663	7221545.8887	584623.7069	900.629	LOTE
P664	7221549.1107	584636.9239	901.098	LOTE
P665	7221548.1777	584628.4299	900.840	POSTE



IDENTIF.	NORTE	LESTE	COTA	DESCRIÇÃO
P666	7221550.2647	584641.7629	901.267	MEIOFIO
P667	7221552.6557	584642.1099	901.269	MEIOFIO
P668	7221554.5327	584643.7399	901.253	MEIOFIO
P669	7221556.9617	584653.7959	901.497	MEIOFIO
P670	7221553.3477	584654.7469	901.605	LOTE
P671	7221556.8137	584664.5239	901.849	POSTE
P672	7221556.7077	584669.3309	901.959	LOTE
P673	7221560.3627	584668.5539	901.866	MEIOFIO
P674	7221563.7557	584682.8619	902.255	MEIOFIO
P675	7221560.1477	584683.8539	902.242	LOTE
P676	7221566.1047	584693.1579	902.628	MEIOFIO
P677	7221582.3417	584706.4149	902.736	CERCA
P678	7221579.5007	584694.3419	902.488	CERCA
P679	7221576.6517	584682.2029	902.191	CERCA
P680	7221573.8707	584670.2969	901.672	CERCA
P681	7221570.9837	584658.0099	901.219	CERCA
P682	7221569.2787	584650.7119	900.976	PORTAO
P683	7221568.0757	584645.6889	900.946	PORTAO
P684	7221565.2727	584633.5949	900.675	CERCA
P685	7221562.4067	584621.5469	900.298	CERCA
P686	7221559.5567	584609.3759	900.049	CERCA
P687	7221557.7807	584601.9149	899.999	CERCA
P688	7221537.6027	584593.3499	899.728	POSTE
P689	7221539.6557	584601.2719	899.980	PTOCOTA
P690	7221541.6447	584608.8139	900.227	PTOCOTA
P691	7221560.5947	584559.0349	897.943	POSTE
P692	7221563.1417	584560.2509	898.283	CINAMOMO





IDENTIF.	NORTE	LESTE	COTA	DESCRIÇÃO
P693	7221562.6997	584560.5339	898.410	CINAMOMO
P694	7221563.0677	584561.2329	898.324	CINAMOMO
P695	7221554.2217	584557.2509	898.155	VIAPAV
P696	7221554.0487	584553.9909	898.209	VIAPAV
P697	7221554.1477	584550.7889	898.154	VIAPAV
P698	7221559.2967	584550.0949	898.121	MEIOFIO
P699	7221558.7887	584545.9919	897.970	LOTE
P700	7221543.9267	584546.4529	898.159	ESQUINA
P701	7221544.3547	584550.7329	898.408	MEIOFIO
P702	7221541.2257	584549.7239	898.352	MEIOFIO
P703	7221539.7177	584547.7339	898.323	MEIOFIO
P704	7221537.4767	584538.0729	898.053	MEIOFIO
P705	7221536.8567	584538.1749	897.971	VIAPAV
P706	7221533.8707	584538.7219	898.102	VIAPAV
P707	7221530.4097	584539.1399	898.100	VIAPAV
P708	7221526.6387	584530.6429	897.723	POSTE
P709	7221527.5307	584526.2169	897.570	VIAPAV
P710	7221534.0847	584523.8079	897.441	VIAPAV
P711	7221530.7297	584524.6399	897.585	VIAPAV
P712	7221539.5297	584526.8359	897.613	LOTE
P713	7221537.7287	584531.2059	897.754	LEUCENA
P714	7221537.5257	584531.6239	897.774	LEUCENA
P715	7221537.8847	584531.7729	897.755	LEUCENA
P716	7221535.1477	584507.0939	896.511	ESQUINA
P717	7221531.2817	584511.3159	896.726	VIAPAV
P718	7221527.8147	584511.4069	896.823	VIAPAV
P719	7221524.1187	584511.0119	896.809	VIAPAV



IDENTIF.	NORTE	LESTE	COTA	DESCRIÇÃO
P720	7221521.7067	584508.5209	896.647	VIAPAV
P721	7221518.2837	584508.4199	896.641	VIAPAV
P722	7221502.5317	584517.1779	897.118	LOTE
P723	7221501.8037	584514.2399	897.118	MEIOFIO
P724	7221503.6597	584513.1539	896.891	VIAPAV
P725	7221510.2687	584511.0679	896.745	VIAPAV
P726	7221532.0987	584506.3289	896.390	MEIOFIO
P727	7221533.1577	584504.7059	896.265	MEIOFIO
P728	7221533.8057	584504.1159	896.189	MEIOFIO
P729	7221534.6307	584503.8329	896.162	MEIOFIO
P730	7221524.5497	584550.1339	898.527	POSTE
P731	7221531.9937	584546.5989	898.349	VIAPAV
P732	7221531.1697	584549.4859	898.422	VIAPAV
P733	7221529.6467	584551.7849	898.459	VIAPAV
P734	7221526.5247	584553.6909	898.573	VIAPAV
P735	7221527.0607	584556.7489	898.611	VIAPAV
P736	7221527.7197	584560.2109	898.597	VIAPAV
P737	7221532.9137	584559.0229	898.504	VIAPAV
P738	7221539.5557	584557.6339	898.432	VIAPAV
P739	7221545.3507	584557.8459	898.319	VIAPAV
P740	7221549.7227	584557.7269	898.243	VIAPAV
P741	7221551.4017	584574.8639	899.034	CERCA
P742	7221544.6607	584562.9189	898.458	VIANPAV
P743	7221545.9797	584560.5619	898.379	VIANPAV
P744	7221547.5127	584559.0259	898.323	VIANPAV
P745	7221536.3847	584563.7759	898.655	VIANPAV
P746	7221535.2867	584560.6919	898.573	VIANPAV



IDENTIF.	NORTE	LESTE	COTA	DESCRIÇÃO
P747	7221532.2667	584559.0429	898.503	VIANPAV
P748	7221521.4277	584561.8629	898.701	VIAPAV
P749	7221520.4527	584558.7709	898.745	VIAPAV
P750	7221519.6347	584555.4659	898.676	VIAPAV
P751	7221510.4037	584550.9719	898.580	LOTE
P752	7221511.8407	584557.8159	898.793	VIAPAV
P753	7221512.6977	584561.0519	898.885	VIAPAV
P754	7221513.5427	584564.4229	898.817	VIAPAV
P755	7221505.0387	584567.0679	898.975	VIAPAV
P756	7221504.0027	584563.8379	899.010	VIAPAV
P757	7221502.8427	584560.5539	898.896	VIAPAV
P758	7221495.7877	584555.0769	898.728	LOTE
P759	7221489.2407	584559.9039	898.627	POSTE
P760	7221490.6207	584565.1189	899.031	VIAPAV
P761	7221491.9167	584568.3299	899.124	VIAPAV
P762	7221493.1747	584571.6709	899.081	VIAPAV
P763	7221484.4977	584575.3449	899.107	VIAPAV
P764	7221483.3477	584571.9869	899.159	VIAPAV
P765	7221482.1007	584568.8249	899.071	VIAPAV
P766	7221473.3687	584573.0109	899.097	VIAPAV
P767	7221474.8057	584576.1459	899.161	VIAPAV
P768	7221476.3147	584579.1649	899.143	VIAPAV
P769	7221468.1327	584583.3779	899.120	VIAPAV
P770	7221466.6337	584580.4189	899.140	VIAPAV
P771	7221464.9897	584577.5879	899.086	VIAPAV
P772	7221457.6647	584576.4879	898.940	POSTE
P773	7221455.4997	584583.3339	898.957	VIAPAV



IDENTIF.	NORTE	LESTE	COTA	DESCRIÇÃO
P774	7221457.0297	584586.0949	899.033	VIAPAV
P775	7221458.6137	584589.0289	899.005	VIAPAV
P776	7221451.7227	584593.2909	898.897	VIAPAV
P777	7221450.1347	584590.2879	898.933	VIAPAV
P778	7221448.5117	584587.7019	898.847	VIAPAV
P779	7221441.7207	584592.2369	898.747	VIAPAV
P780	7221443.1057	584594.7609	898.802	VIAPAV
P781	7221444.7437	584597.5319	898.763	VIAPAV
P782	7221437.4787	584602.6639	898.603	VIAPAV
P783	7221435.9067	584599.7179	898.643	VIAPAV
P784	7221434.1487	584596.6629	898.481	VIAPAV
P785	7221430.3057	584596.6229	898.492	POSTE
P786	7221429.9377	584598.8489	898.020	BOCALEAO
P787	7221429.3717	584598.0559	897.956	BOCALEAO
P788	7221428.2957	584598.7469	898.107	BOCALEAO
P789	7221428.5827	584599.4919	898.156	BOCALEAO
P790	7221428.5887	584600.9409	898.312	VIAPAV
P791	7221425.5437	584601.7259	898.145	VIAPAV
P792	7221422.8777	584601.0969	897.894	VIAPAV
P793	7221421.3857	584599.4749	897.762	VIAPAV
P794	7221412.2337	584607.3129	897.928	ESQUINA
P795	7221414.2767	584608.9939	898.135	PVSANEP
P796	7221413.7767	584609.2689	898.126	PVSANEP
P797	7221414.2927	584609.5209	898.139	PVSANEP
P798	7221413.8137	584611.0339	898.191	MEIOFIO
P799	7221414.9457	584608.4589	898.135	MEIOFIO
P800	7221415.0137	584607.0189	898.091	MEIOFIO





IDENTIF.	NORTE	LESTE	COTA	DESCRIÇÃO
P801	7221430.4887	584607.6459	898.496	VIAPAV
P802	7221428.8887	584604.5209	898.465	VIAPAV
P803	7221595.7097	584689.3419	901.771	CAPAO
P804	7221594.2437	584666.8449	900.924	CAPAO
P807	7221603.2147	584649.5939	900.335	CAPAO
P808	7221610.7897	584633.3549	899.436	CAPAO
P809	7221613.4947	584642.8329	899.491	CAPAO
P810	7221622.6377	584660.0539	899.924	CAPAO
P811	7221632.3367	584667.1339	899.777	CAPAO
P812	7221656.6317	584683.3189	899.412	CERCA
P813	7221575.2597	584618.9659	899.818	EUCALIPT [ [ [
P814	7221574.6167	584619.5449	899.996	EUCALIPT [ [ [
P815	7221574.3667	584618.9879	899.998	EUCALIPT [ [ [
P816	7221567.0947	584618.7739	900.224	EUCALIPT [ [ [
P817	7221566.9677	584619.2889	900.237	EUCALIPT [ [ [
P818	7221566.6287	584618.9149	900.279	EUCALIPT [ [ [
P819	7221566.7537	584623.2869	900.429	EUCALIPT [ [ [
P820	7221567.1017	584623.6409	900.318	EUCALIPT [ [ [
P821	7221566.6707	584623.7329	900.437	EUCALIPT [ [ [
P822	7221566.1377	584624.2189	900.522	EUCALIPT [ [ [
P823	7221566.3417	584624.7539	900.332	EUCALIPT [ [ [
P824	7221565.4647	584624.7839	900.566	EUCALIPT [ [ [
P825	7221567.6937	584625.5239	900.166	MONUMENT [ [ [
P826	7221568.2047	584625.2009	900.170	MONUMENT [ [ [
P827	7221568.4747	584625.6399	900.223	MONUMENT [ [ [
P828	7221568.0097	584625.9549	900.223	MONUMENT [ [ [
P829	7221670.2407	584663.5659	898.062	CERCA



IDENTIF.	NORTE	LESTE	COTA	DESCRIÇÃO
P830	7221666.7217	584659.8029	898.320	ARVORE
P831	7221666.3567	584659.5799	898.322	ARVORE
P832	7221666.0797	584659.9379	898.348	ARVORE
P833	7221641.4507	584565.7379	895.963	CAPAO
P834	7221644.8567	584576.6539	895.739	CAPAO
P835	7221643.4047	584591.0039	896.248	CAPAO
P836	7221629.9847	584594.8979	898.009	CAPAO
P837	7221616.1357	584595.7689	898.700	CAPAO
P838	7221616.5767	584602.7089	898.239	CAPAO
P839	7221629.1607	584608.4469	898.161	CAPAO
P840	7221639.6477	584617.0189	898.122	CAPAO
P841	7221649.6777	584611.9739	897.929	CAPAO
P842	7221664.3777	584630.8899	898.399	CAPAO
P843	7221675.6167	584649.6519	898.257	CAPAO
P844	7221688.5257	584659.4159	897.486	CERCA
P845	7221671.8137	584626.9089	896.247	TALUDE
P846	7221662.5447	584617.7149	896.440	TALUDE
P847	7221653.8777	584607.4779	896.522	TALUDE
P848	7221643.2787	584600.5099	897.188	TALUDE
P849	7221630.9587	584591.8089	896.672	TALUDE
P850	7221617.4777	584587.7369	897.499	TALUDE
P851	7221603.4087	584584.7539	898.284	TALUDE
P852	7221606.2807	584589.0699	898.748	TALUDE
P853	7221619.2867	584594.5449	898.620	TALUDE
P854	7221632.2117	584599.7709	898.216	TALUDE
P855	7221643.5167	584605.6489	898.193	TALUDE
P856	7221654.0997	584615.7119	897.821	TALUDE



IDENTIF.	NORTE	LESTE	COTA	DESCRIÇÃO
P857	7221663.8117	584624.9299	898.126	TALUDE
P858	7221672.4167	584635.0339	898.095	TALUDE
P859	7221564.9167	584576.2789	898.809	CAPAO
P860	7221569.1127	584562.4439	898.112	CAPAO
P861	7221572.4467	584575.5539	898.213	TALUDE
P862	7221568.9407	584581.6079	899.495	TALUDE
P863	7221592.5457	584581.7719	898.457	TALUDE
P864	7221594.1387	584585.6179	898.896	TALUDE
StkdCT01	7221598.9137	584711.1709	902.389	COTA
StkdCT02	7221595.5007	584696.6589	902.219	COTA
StkdCT03	7221592.0257	584681.9839	901.763	COTA
StkdCT04	7221588.5987	584667.3839	901.243	COTA
StkdCT05	7221585.1727	584652.7659	900.860	COTA
StkdCT06	7221581.7427	584638.1829	900.381	COTA
StkdCT07	7221578.3007	584623.5639	899.907	COTA
StkdCT08	7221574.8737	584608.9739	899.656	COTA
StkdCT09	7221571.4357	584594.3629	899.516	COTA
StkdCT10	7221567.9867	584579.7729	899.037	COTA
StkdCT11	7221564.5617	584565.1649	898.124	COTA
StkdCT12	7221579.1627	584561.7379	897.970	COTA
StkdCT13	7221582.5907	584576.3389	898.321	COTA
StkdCT14	7221586.0387	584590.9289	898.462	COTA
StkdCT15	7221589.4597	584605.5229	899.281	COTA
StkdCT16	7221592.9137	584620.1349	899.426	COTA
StkdCT17	7221596.3447	584634.7379	899.824	COTA
StkdCT18	7221599.8007	584649.3279	900.347	COTA
StkdCT19	7221603.2137	584663.9579	900.481	COTA



IDENTIF.	NORTE	LESTE	COTA	DESCRIÇÃO
StkdCT20	7221606.6297	584678.5359	900.914	COTA
StkdCT21	7221610.0657	584693.1519	901.360	COTA
StkdCT22	7221613.5107	584707.7599	901.956	COTA
StkdCT23	7221628.1047	584704.3169	901.182	COTA
StkdCT24	7221624.6747	584689.7009	900.692	COTA
StkdCT25	7221621.2467	584675.1149	900.341	COTA
StkdCT26	7221617.7937	584660.5109	899.936	COTA
StkdCT27	7221614.3757	584645.9029	899.618	COTA
StkdCT28	7221610.9457	584631.2919	899.306	COTA
StkdCT29	7221607.5007	584616.7129	898.849	COTA
StkdCT30	7221604.0817	584602.1059	898.804	COTA
StkdCT31	7221600.6427	584587.5029	898.776	COTA
StkdCT32	7221597.2077	584572.8929	897.915	COTA
StkdCT33	7221612.0247	584569.0789	896.931	COTA
StkdCT34	7221615.2337	584584.0559	897.486	COTA
StkdCT35	7221618.6737	584598.6689	898.353	COTA
StkdCT36	7221622.1587	584613.2829	898.632	COTA
StkdCT37	7221625.5407	584627.8539	898.770	COTA
StkdCT38	7221628.9587	584642.4699	899.092	COTA
StkdCT39	7221632.3897	584657.0619	899.429	COTA
StkdCT40	7221635.8327	584671.6769	899.898	COTA
StkdCT41	7221639.2747	584686.2749	900.124	COTA
StkdCT42	7221642.7027	584700.8869	900.388	COTA
StkdCT43	7221657.3057	584697.4479	899.763	COTA
StkdCT44	7221653.8747	584682.8439	899.498	COTA
StkdCT45	7221650.4887	584668.3519	899.110	COTA
StkdCT46	7221647.0337	584653.6339	898.885	COTA





IDENTIF.	NORTE	LESTE	COTA	DESCRIÇÃO
StkdCT47	7221643.5947	584639.0499	898.445	COTA
StkdCT48	7221640.1287	584624.4359	898.377	COTA
StkdCT49	7221636.7187	584609.7749	898.387	COTA
StkdCT50	7221633.2627	584595.2089	897.723	COTA
StkdCT51	7221629.8517	584580.6309	896.615	COTA
StkdCT52	7221626.4087	584566.0389	896.337	COTA
StkdCT53	7221644.4387	584577.1839	895.835	COTA
StkdCT54	7221647.8877	584591.7879	896.109	COTA
StkdCT55	7221651.3077	584606.4089	896.682	COTA
StkdCT56	7221654.7417	584620.9969	898.412	COTA
StkdCT57	7221658.1747	584635.6059	897.916	COTA
StkdCT58	7221661.6017	584650.1939	898.136	COTA
StkdCT59	7221676.1767	584646.7699	898.415	COTA
StkdCT60	7221672.7897	584632.1609	897.084	COTA
StkdCT61	7221669.3337	584617.5609	896.036	COTA
StkdCT62	7221665.9067	584602.9689	895.556	COTA
StkdCT63	7221662.4707	584588.3789	895.304	COTA
StkdCT64	7221680.2177	584599.2209	894.429	COTA
StkdCT65	7221683.9187	584614.1359	895.206	COTA
StkdCT66	7221687.0537	584628.6579	895.504	COTA
StkdCT67	7221690.7877	584643.3209	895.875	COTA
StkdCT68	7221705.3797	584639.9399	894.626	COTA
StkdCT69	7221701.9867	584625.3049	894.090	COTA
StkdSONDAGEM01	7221603.0447	584689.8059	901.507	06 03 20
StkdSONDAGEM02	7221609.5117	584676.8289	900.755	06 03 20
StkdSONDAGEM03	7221591.1447	584666.1499	901.172	06 03 20
StkdSONDAGEM04	7221582.3267	584614.8829	899.674	06 03 20



IDENTIF.	NORTE	LESTE	COTA	DESCRIÇÃO
StkdSONDAGEM05	7221604.2547	584639.4619	899.753	06 03 20
StkdSONDAGEM06	7221626.2477	584661.8869	899.854	06 03 20
StkdSONDAGEM07	7221602.9167	584610.0469	898.914	06 03 20
StkdSONDAGEM08	7221630.2577	584630.8349	898.747	06 03 20
StkdSONDAGEM09	7221651.9967	584678.3839	899.379	06 03 20
StkdSONDAGEM10	7221646.2867	584647.7029	898.612	06 03 20
StkdSONDAGEM11	7221667.5097	584634.9409	898.407	06 03 20
StkdSONDAGEM12	7221651.2967	584597.5489	896.372	06 03 20
Z_01	7221775.3647	584684.8559	890.284	AUXILIAR
Z_02	7221762.5557	584669.3729	890.808	AUXILIAR
Z_03	7221738.0567	584644.1019	891.937	AUXILIAR
Z_04	7221714.7447	584620.8459	892.986	AUXILIAR
Z_05	7221690.6927	584597.1889	893.744	AUXILIAR
Z_06	7221665.3347	584572.5009	894.302	AUXILIAR
Z_07	7221641.7227	584549.9659	895.090	AUXILIAR
Z_08	7221593.8267	584552.1929	897.058	AUXILIAR
Z_09	7221560.2137	584553.7499	898.094	AUXILIAR
Z_10	7221537.1157	584555.0049	898.469	AUXILIAR
Z_11	7221554.3917	584626.9209	900.766	AUXILIAR
Z_12	7221562.9057	584663.1179	901.664	AUXILIAR
Z_13	7221571.1417	584698.1589	902.789	AUXILIAR
Z_14	7221579.0467	584731.0309	903.435	AUXILIAR
Z_15	7221606.3007	584556.2779	896.668	AUXILIAR
Z_16	7221568.2507	584661.8529	901.319	AUXILIAR



A seguir os 961 pontos topográficos são apresentados em medidas angulares:

IDENTIF.	LATITUDE	LONGITUDE	COTA	DESCRIÇÃO
P001	25°07'09.23493" S	50°09'36.07975" W	902.178	CERCA
P002	25°07'08.94896" S	50°09'34.78639" W	902.909	CERCA
P004	25°07'09.83111" S	50°09'40.37396" W	898.058	CERCA
P005	25°07'09.91355" S	50°09'40.41453" W	898.093	CERCA
P006	25°07'09.99837" S	50°09'40.42634" W	898.173	CERCA
P007	25°07'10.09453" S	50°09'40.40201" W	898.324	CERCA
P008	25°07'10.17776" S	50°09'40.36945" W	898.521	CERCA
P009	25°07'07.46817" S	50°09'40.46236" W	895.889	CERCA
P010	25°07'06.89051" S	50°09'40.26113" W	894.942	CERCA
P011	25°07'04.95907" S	50°09'38.08233" W	893.513	CERCA
P012	25°07'04.89521" S	50°09'38.01639" W	893.641	CERCA
P013	25°07'04.66779" S	50°09'37.74803" W	893.526	CERCA
P014	25°07'06.75667" S	50°09'36.61948" W	899.071	CERCA
P015	25°07'02.39588" S	50°09'34.83220" W	891.148	CERCA
P016	25°07'02.42519" S	50°09'34.91466" W	891.028	CERCA
P017	25°07'02.46933" S	50°09'35.00041" W	891.009	CERCA
P018	25°07'02.65187" S	50°09'35.35491" W	891.072	CERCA
P019	25°07'03.02139" S	50°09'35.75045" W	891.693	CERCA
P020	25°07'04.25397" S	50°09'37.28096" W	892.781	CERCA
P021	25°07'04.64265" S	50°09'38.43585" W	892.880	POSTE
P022	25°07'04.12849" S	50°09'37.96517" W	892.155	LOTE
P023	25°07'03.73753" S	50°09'37.54004" W	892.036	LOTE
P024	25°07'03.88316" S	50°09'37.60160" W	892.012	POSTE
P025	25°07'03.27614" S	50°09'36.93364" W	890.735	BOCALEAO
P026	25°07'03.29655" S	50°09'36.90975" W	890.799	BOCALEAO
P027	25°07'03.25522" S	50°09'36.87344" W	890.899	BOCALEAO



IDENTIF.	LATITUDE	LONGITUDE	COTA	DESCRIÇÃO
P028	25°07'03.23816" S	50°09'36.89794" W	890.906	BOCALEAO
P029	25°07'03.27296" S	50°09'36.91056" W	889.783	BOCALEAO
P030	25°07'03.05920" S	50°09'36.70331" W	890.626	POSTE
P031	25°07'02.14482" S	50°09'36.71402" W	887.676	POSTE
P032	25°07'01.70774" S	50°09'36.95000" W	885.606	LOTE
P033	25°07'01.70205" S	50°09'36.76161" W	885.621	BOCALEAO
P034	25°07'01.71359" S	50°09'36.79463" W	885.597	BOCALEAO
P035	25°07'01.66735" S	50°09'36.81063" W	885.694	BOCALEAO
P036	25°07'01.65688" S	50°09'36.78110" W	885.680	BOCALEAO
P037	25°07'01.23981" S	50°09'37.11273" W	884.198	LOTE
P038	25°07'00.99173" S	50°09'37.13375" W	882.434	POSTE
P039	25°07'00.67798" S	50°09'37.31107" W	880.747	ESQUINA
P040	25°07'00.25328" S	50°09'36.86996" W	880.017	ESQUINA
P041	25°07'00.67008" S	50°09'37.18001" W	880.840	BOCALOBO
P042	25°07'00.70046" S	50°09'37.17009" W	880.967	BOCALOBO
P043	25°07'00.81136" S	50°09'36.84529" W	882.313	BOCALOBO
P044	25°07'00.83773" S	50°09'36.83450" W	882.457	BOCALOBO
P045	25°07'00.82585" S	50°09'36.79342" W	882.623	BOCALOBO
P046	25°07'00.79783" S	50°09'36.80482" W	882.496	BOCALOBO
P047	25°07'00.76280" S	50°09'36.68651" W	882.556	LOTE
P048	25°07'01.26886" S	50°09'36.50798" W	884.375	LOTE
P049	25°07'02.24401" S	50°09'36.55456" W	887.707	BOCALEAO
P050	25°07'02.25220" S	50°09'36.57657" W	887.733	BOCALEAO
P051	25°07'02.28412" S	50°09'36.57035" W	887.799	BOCALEAO
P052	25°07'02.27412" S	50°09'36.53803" W	887.764	BOCALEAO
P053	25°07'02.26849" S	50°09'36.24496" W	888.423	BOCALEAO
P054	25°07'02.26149" S	50°09'36.22529" W	888.454	BOCALEAO





IDENTIF.	LATITUDE	LONGITUDE	COTA	DESCRIÇÃO
P055	25°07'02.29003" S	50°09'36.21414" W	888.529	BOCALEAO
P056	25°07'02.29631" S	50°09'36.23191" W	888.516	BOCALEAO
P057	25°07'02.38221" S	50°09'36.11296" W	888.824	LOTE
P058	25°07'02.41248" S	50°09'36.08608" W	888.935	LOTE
P059	25°07'02.41881" S	50°09'36.04333" W	889.059	LOTE
P060	25°07'02.40184" S	50°09'36.00866" W	889.145	LOTE
P061	25°07'02.07438" S	50°09'35.53975" W	889.222	LOTE
P062	25°07'02.21481" S	50°09'35.62420" W	889.452	POSTE
P063	25°07'01.87577" S	50°09'35.00976" W	889.249	LOTE
P064	25°07'02.08133" S	50°09'34.95233" W	890.260	MEIOFIO
P065	25°07'02.14151" S	50°09'35.12631" W	890.251	MEIOFIO
P066	25°07'02.25251" S	50°09'35.38660" W	890.147	MEIOFIO
P067	25°07'02.35771" S	50°09'35.59420" W	890.144	MEIOFIO
P068	25°07'02.43954" S	50°09'35.74271" W	890.123	MEIOFIO
P069	25°07'02.56291" S	50°09'35.93908" W	890.040	MEIOFIO
P070	25°07'02.57224" S	50°09'35.96644" W	889.999	MEIOFIO
P071	25°07'02.52154" S	50°09'36.10186" W	889.432	MEIOFIO
P072	25°07'02.50576" S	50°09'36.12779" W	889.374	MEIOFIO
P073	25°07'02.41951" S	50°09'36.19579" W	889.004	MEIOFIO
P074	25°07'02.20284" S	50°09'36.28197" W	888.225	MEIOFIO
P075	25°07'01.96093" S	50°09'36.37899" W	887.331	MEIOFIO
P076	25°07'01.71338" S	50°09'36.47767" W	886.351	MEIOFIO
P077	25°07'01.46541" S	50°09'36.57555" W	885.327	MEIOFIO
P078	25°07'01.31585" S	50°09'36.63560" W	884.617	MEIOFIO
P079	25°07'01.08030" S	50°09'36.72926" W	883.699	MEIOFIO
P080	25°07'00.84180" S	50°09'36.82451" W	882.640	MEIOFIO
P081	25°07'00.58244" S	50°09'36.92819" W	881.233	MEIOFIO



IDENTIF.	LATITUDE	LONGITUDE	COTA	DESCRIÇÃO
P082	25°07'00.42651" S	50°09'36.98857" W	880.443	MEIOFIO
P083	25°07'00.31056" S	50°09'37.01814" W	879.858	MEIOFIO
P084	25°07'00.21236" S	50°09'36.98621" W	879.674	MEIOFIO
P085	25°07'00.16043" S	50°09'36.89751" W	879.685	MEIOFIO
P086	25°06'59.93961" S	50°09'36.97369" W	879.563	MEIOFIO
P087	25°06'59.98544" S	50°09'37.08117" W	879.457	MEIOFIO
P088	25°06'59.97433" S	50°09'37.13573" W	879.176	MEIOFIO
P089	25°06'59.92697" S	50°09'37.16998" W	878.907	MEIOFIO
P090	25°06'59.94147" S	50°09'37.03377" W	879.577	PVTELEF
P091	25°06'59.93633" S	50°09'37.00909" W	879.572	PVTELEF
P092	25°06'59.92395" S	50°09'37.02839" W	879.573	PVTELEF
P093	25°06'59.81289" S	50°09'37.28988" W	878.145	PVSANEP
P094	25°06'59.80381" S	50°09'37.30615" W	878.094	PVSANEP
P095	25°06'59.82053" S	50°09'37.30771" W	878.148	PVSANEP
P096	25°07'00.53213" S	50°09'37.27482" W	880.256	MEIOFIO
P097	25°07'00.65847" S	50°09'37.19576" W	880.919	MEIOFIO
P098	25°07'00.72129" S	50°09'37.16919" W	881.243	MEIOFIO
P099	25°07'00.95792" S	50°09'37.07113" W	882.433	MEIOFIO
P100	25°07'01.13100" S	50°09'36.99675" W	883.380	MEIOFIO
P101	25°07'01.12059" S	50°09'36.98461" W	883.139	VIAPAV
P102	25°07'01.07915" S	50°09'36.86521" W	883.403	VIAPAV
P103	25°07'00.78150" S	50°09'36.87110" W	882.159	VIAPAV
P104	25°07'00.81649" S	50°09'36.96512" W	882.135	VIAPAV
P105	25°07'00.85996" S	50°09'37.08173" W	881.897	VIAPAV
P106	25°07'00.47689" S	50°09'37.25056" W	880.048	VIAPAV
P107	25°07'00.43476" S	50°09'37.13005" W	880.132	VIAPAV
P108	25°07'00.40381" S	50°09'37.02004" W	880.153	VIAPAV



IDENTIF.	LATITUDE	LONGITUDE	COTA	DESCRIÇÃO
P109	25°07'01.03544" S	50°09'36.76956" W	883.351	VIAPAV
P110	25°07'01.29827" S	50°09'36.66604" W	884.492	VIAPAV
P111	25°07'01.34270" S	50°09'36.76268" W	884.545	VIAPAV
P112	25°07'01.38131" S	50°09'36.88017" W	884.305	VIAPAV
P113	25°07'01.75982" S	50°09'36.74340" W	885.856	VIAPAV
P114	25°07'01.73325" S	50°09'36.60990" W	886.141	VIAPAV
P115	25°07'01.70779" S	50°09'36.49938" W	886.190	VIAPAV
P116	25°07'02.02639" S	50°09'36.38158" W	887.432	VIAPAV
P117	25°07'02.06102" S	50°09'36.48550" W	887.402	VIAPAV
P118	25°07'02.10299" S	50°09'36.61222" W	887.172	VIAPAV
P119	25°07'02.40143" S	50°09'36.47628" W	888.262	VIAPAV
P120	25°07'02.37218" S	50°09'36.35151" W	888.554	VIAPAV
P121	25°07'02.34132" S	50°09'36.25303" W	888.597	VIAPAV
P122	25°07'02.52183" S	50°09'36.14085" W	889.308	VIAPAV
P123	25°07'02.61134" S	50°09'36.26450" W	889.476	VIAPAV
P124	25°07'02.59899" S	50°09'36.40148" W	888.993	VIAPAV
P125	25°07'02.70604" S	50°09'36.39533" W	889.321	VIAPAV
P126	25°07'02.83608" S	50°09'36.40197" W	889.904	VIAPAV
P127	25°07'02.94301" S	50°09'36.46605" W	890.283	VIAPAV
P128	25°07'02.19308" S	50°09'34.89815" W	890.379	VIAPAV
P129	25°07'02.30875" S	50°09'34.86436" W	890.450	VIAPAV
P130	25°07'02.41405" S	50°09'35.15726" W	890.424	VIAPAV
P131	25°07'02.31342" S	50°09'35.21194" W	890.334	VIAPAV
P132	25°07'02.24472" S	50°09'35.31399" W	890.147	VIAPAV
P133	25°07'02.09594" S	50°09'34.93341" W	890.221	VIAPAV
P134	25°07'02.44294" S	50°09'35.70677" W	890.066	VIAPAV
P135	25°07'02.53320" S	50°09'35.65688" W	890.248	VIAPAV



IDENTIF.	LATITUDE	LONGITUDE	COTA	DESCRIÇÃO
P136	25°07'02.63175" S	50°09'35.59132" W	890.368	VIAPAV
P137	25°07'02.75652" S	50°09'35.78107" W	890.372	VIAPAV
P138	25°07'02.65986" S	50°09'35.86522" W	890.246	VIAPAV
P139	25°07'02.59053" S	50°09'35.93525" W	890.004	VIAPAV
P140	25°07'02.73912" S	50°09'36.14626" W	890.069	VIAPAV
P141	25°07'02.81634" S	50°09'36.09067" W	890.308	VIAPAV
P142	25°07'02.91561" S	50°09'36.02629" W	890.489	VIAPAV
P143	25°07'03.16306" S	50°09'36.36210" W	890.706	VIAPAV
P144	25°07'03.06665" S	50°09'36.42846" W	890.614	VIAPAV
P145	25°07'03.13813" S	50°09'36.17967" W	890.647	VIAPAV
P146	25°07'02.95969" S	50°09'35.85995" W	890.526	VIAPAV
P147	25°07'03.24326" S	50°09'36.31099" W	890.952	POSTE
P148	25°07'03.36610" S	50°09'36.60709" W	891.026	VIAPAV
P149	25°07'03.28814" S	50°09'36.68754" W	890.962	VIAPAV
P150	25°07'03.19718" S	50°09'36.76857" W	890.770	VIAPAV
P151	25°07'03.43394" S	50°09'36.68190" W	891.098	BOCALEAO
P152	25°07'03.45483" S	50°09'36.66101" W	891.180	BOCALEAO
P153	25°07'03.49177" S	50°09'36.69836" W	891.061	BOCALEAO
P154	25°07'03.47011" S	50°09'36.71961" W	891.090	BOCALEAO
P155	25°07'03.62067" S	50°09'36.89379" W	891.300	VIAPAV
P156	25°07'03.53735" S	50°09'36.97317" W	891.282	VIAPAV
P157	25°07'03.45349" S	50°09'37.05701" W	891.143	VIAPAV
P158	25°07'03.66998" S	50°09'37.29944" W	891.449	VIAPAV
P159	25°07'03.75743" S	50°09'37.21315" W	891.587	VIAPAV
P160	25°07'03.83688" S	50°09'37.12769" W	891.572	VIAPAV
P161	25°07'04.04279" S	50°09'37.35581" W	891.865	VIAPAV
P162	25°07'03.95998" S	50°09'37.43454" W	891.885	VIAPAV





IDENTIF.	LATITUDE	LONGITUDE	COTA	DESCRIÇÃO
P163	25°07'03.86707" S	50°09'37.48631" W	891.757	VIAPAV
P164	25°07'04.06803" S	50°09'37.70346" W	892.056	VIAPAV
P165	25°07'04.13305" S	50°09'37.62868" W	892.149	VIAPAV
P166	25°07'04.21689" S	50°09'37.54201" W	892.138	VIAPAV
P167	25°07'04.42532" S	50°09'37.76826" W	892.454	VIAPAV
P168	25°07'04.34558" S	50°09'37.85046" W	892.468	VIAPAV
P169	25°07'04.25776" S	50°09'37.92883" W	892.318	VIAPAV
P170	25°07'04.46971" S	50°09'38.16141" W	892.626	VIAPAV
P171	25°07'04.54887" S	50°09'38.07592" W	892.748	VIAPAV
P172	25°07'04.62773" S	50°09'37.98765" W	892.728	VIAPAV
P173	25°07'04.82776" S	50°09'38.20631" W	892.969	VIAPAV
P174	25°07'04.67064" S	50°09'38.37878" W	892.882	VIAPAV
P175	25°07'04.85551" S	50°09'38.56626" W	893.097	VIAPAV
P176	25°07'04.92764" S	50°09'38.48429" W	893.172	VIAPAV
P177	25°07'04.99814" S	50°09'38.39586" W	893.157	VIAPAV
P178	25°07'05.20194" S	50°09'38.61542" W	893.336	VIAPAV
P179	25°07'05.13254" S	50°09'38.70138" W	893.363	VIAPAV
P180	25°07'05.05205" S	50°09'38.78227" W	893.267	VIAPAV
P181	25°07'04.07015" S	50°09'37.11839" W	892.548	PTOCOTA
P182	25°07'03.86021" S	50°09'36.83827" W	892.818	PTOCOTA
P183	25°07'03.61897" S	50°09'36.54762" W	892.222	PTOCOTA
P184	25°07'03.39003" S	50°09'36.18277" W	892.257	PTOCOTA
P185	25°07'03.42814" S	50°09'36.06381" W	892.342	PTOCOTA
P186	25°07'03.90711" S	50°09'35.98673" W	893.247	PTOCOTA
P187	25°07'04.26688" S	50°09'35.95139" W	894.559	PTOCOTA
P188	25°07'04.71917" S	50°09'35.88677" W	895.901	PTOCOTA
P189	25°07'05.07802" S	50°09'35.73357" W	897.065	PTOCOTA



IDENTIF.	LATITUDE	LONGITUDE	COTA	DESCRIÇÃO
P190	25°07'04.66171" S	50°09'35.65468" W	895.093	VIANPAV
P191	25°07'04.52127" S	50°09'35.46436" W	894.580	VIANPAV
P192	25°07'04.63287" S	50°09'35.53915" W	895.121	VIANPAV
P193	25°07'04.73987" S	50°09'35.29954" W	896.100	CERCA
P194	25°07'03.97206" S	50°09'35.50464" W	894.095	CERCA
P195	25°07'03.93727" S	50°09'35.61800" W	892.754	VIANPAV
P196	25°07'03.87041" S	50°09'35.74000" W	892.716	VIANPAV
P197	25°07'03.86665" S	50°09'35.86325" W	892.420	VIANPAV
P198	25°07'03.43834" S	50°09'35.99426" W	891.476	VIANPAV
P199	25°07'03.40971" S	50°09'35.85220" W	891.469	VIANPAV
P200	25°07'03.38455" S	50°09'35.73864" W	891.470	VIANPAV
P201	25°07'03.30838" S	50°09'35.67439" W	892.615	CERCA
P202	25°07'03.06660" S	50°09'35.82280" W	890.651	VIANPAV
P203	25°07'03.16756" S	50°09'35.93548" W	890.875	VIANPAV
P204	25°07'03.25739" S	50°09'36.04499" W	890.928	VIANPAV
P205	25°07'03.34776" S	50°09'35.98067" W	891.238	BOCALEAO
P206	25°07'03.35305" S	50°09'36.02016" W	891.325	BOCALEAO
P207	25°07'03.39190" S	50°09'36.00811" W	891.460	BOCALEAO
P208	25°07'03.38903" S	50°09'35.97335" W	891.387	BOCALEAO
P209	25°07'04.84471" S	50°09'37.11931" W	894.543	CERCA
P210	25°07'05.21920" S	50°09'37.01891" W	895.164	CERCA
P211	25°07'06.05670" S	50°09'40.11310" W	893.313	LOTE
P212	25°07'05.85397" S	50°09'39.72307" W	893.738	LEUCENA
P213	25°07'05.84897" S	50°09'39.70689" W	893.783	LEUCENA
P214	25°07'05.84037" S	50°09'39.72030" W	893.675	LEUCENA
P215	25°07'05.67079" S	50°09'39.67822" W	893.246	LOTE
P216	25°07'05.15324" S	50°09'38.92383" W	893.192	BOCALEAO



IDENTIF.	LATITUDE	LONGITUDE	COTA	DESCRIÇÃO
P217	25°07'05.13348" S	50°09'38.94329" W	893.133	BOCALEAO
P218	25°07'05.09898" S	50°09'38.90707" W	893.182	BOCALEAO
P219	25°07'05.11800" S	50°09'38.88476" W	893.359	BOCALEAO
P220	25°07'05.42150" S	50°09'39.29143" W	893.538	POSTE
P221	25°07'04.90771" S	50°09'38.82296" W	892.775	LOTE
P222	25°07'04.52464" S	50°09'38.39463" W	892.572	LOTE
P224	25°07'05.19442" S	50°09'38.94669" W	893.346	VIAPAV
P225	25°07'05.27708" S	50°09'38.85814" W	893.483	VIAPAV
P226	25°07'05.35500" S	50°09'38.77702" W	893.448	VIAPAV
P227	25°07'05.31348" S	50°09'38.71896" W	893.142	BOCALEAO
P228	25°07'05.33279" S	50°09'38.70076" W	893.232	BOCALEAO
P229	25°07'05.27968" S	50°09'38.69177" W	893.316	BOCALEAO
P230	25°07'05.29886" S	50°09'38.66839" W	893.232	BOCALEAO
P231	25°07'05.61937" S	50°09'39.05898" W	893.711	VIAPAV
P232	25°07'05.46372" S	50°09'39.22680" W	893.609	VIAPAV
P233	25°07'05.70704" S	50°09'39.48822" W	893.781	VIAPAV
P234	25°07'05.77728" S	50°09'39.39469" W	893.890	VIAPAV
P235	25°07'05.85892" S	50°09'39.31026" W	893.882	VIAPAV
P236	25°07'06.06106" S	50°09'39.52766" W	894.043	VIAPAV
P237	25°07'05.98858" S	50°09'39.61763" W	894.008	VIAPAV
P238	25°07'05.90779" S	50°09'39.70245" W	893.881	VIAPAV
P239	25°07'06.11718" S	50°09'39.92098" W	893.985	VIAPAV
P240	25°07'06.19774" S	50°09'39.83573" W	894.143	VIAPAV
P241	25°07'06.27330" S	50°09'39.75080" W	894.185	VIAPAV
P242	25°07'06.44545" S	50°09'39.92595" W	894.310	VIAPAV
P243	25°07'06.30193" S	50°09'40.11018" W	894.158	VIAPAV
P244	25°07'06.23223" S	50°09'40.18518" W	893.889	POSTE



IDENTIF.	LATITUDE	LONGITUDE	COTA	DESCRIÇÃO
P245	25°07'06.50612" S	50°09'40.31657" W	894.389	VIAPAV
P246	25°07'06.58421" S	50°09'40.23701" W	894.515	VIAPAV
P247	25°07'06.66165" S	50°09'40.14679" W	894.523	VIAPAV
P248	25°07'06.83490" S	50°09'40.31421" W	894.714	VIAPAV
P249	25°07'06.75439" S	50°09'40.40850" W	894.688	VIAPAV
P250	25°07'06.69029" S	50°09'40.49038" W	894.598	VIAPAV
P251	25°07'06.60558" S	50°09'39.94082" W	894.577	CERCA
P252	25°07'06.32361" S	50°09'39.62181" W	894.425	CERCA
P253	25°07'06.03835" S	50°09'39.30075" W	894.243	CERCA
P254	25°07'05.75412" S	50°09'38.97886" W	894.116	CERCA
P255	25°07'05.46908" S	50°09'38.65802" W	894.075	CERCA
P256	25°07'05.18505" S	50°09'38.33638" W	893.879	CERCA
P257	25°07'06.76224" S	50°09'40.56105" W	894.674	VIAPAV
P258	25°07'06.76735" S	50°09'40.64300" W	894.549	VIAPAV
P259	25°07'06.72553" S	50°09'40.73191" W	894.152	VIAPAV
P260	25°07'06.65097" S	50°09'40.77484" W	893.834	MEIOFIO
P261	25°07'06.66252" S	50°09'40.81151" W	893.717	VIAPAV
P262	25°07'06.68588" S	50°09'40.89587" W	893.674	VIAPAV
P263	25°07'06.71833" S	50°09'40.98256" W	893.571	VIAPAV
P264	25°07'06.72133" S	50°09'41.01260" W	893.603	MEIOFIO
P265	25°07'06.52657" S	50°09'41.06538" W	892.685	BOCALOBO
P266	25°07'06.53530" S	50°09'41.09632" W	892.672	BOCALOBO
P267	25°07'06.56363" S	50°09'41.08713" W	892.810	BOCALOBO
P268	25°07'06.29248" S	50°09'41.15779" W	892.045	MEIOFIO
P269	25°07'06.28482" S	50°09'41.11902" W	892.081	VIAPAV
P270	25°07'06.23884" S	50°09'40.93895" W	892.128	VIAPAV
P271	25°07'06.22864" S	50°09'40.91884" W	892.195	MEIOFIO



IDENTIF.	LATITUDE	LONGITUDE	COTA	DESCRIÇÃO
P272	25°07'06.18072" S	50°09'40.83115" W	891.891	POSTE
P273	25°07'05.69607" S	50°09'41.09998" W	891.112	POSTE
P274	25°07'05.71114" S	50°09'41.12662" W	891.055	VIAPAV
P275	25°07'05.73921" S	50°09'41.21562" W	891.121	VIAPAV
P276	25°07'05.77194" S	50°09'41.30681" W	891.123	VIAPAV
P277	25°07'05.77782" S	50°09'41.33419" W	891.152	MEIOFIO
P278	25°07'05.50342" S	50°09'41.42780" W	890.578	MEIOFIO
P279	25°07'05.49919" S	50°09'41.39858" W	890.494	VIAPAV
P280	25°07'05.47552" S	50°09'41.30608" W	890.498	VIAPAV
P281	25°07'05.45417" S	50°09'41.21003" W	890.439	VIAPAV
P282	25°07'05.44782" S	50°09'41.18440" W	890.520	MEIOFIO
P283	25°07'05.17970" S	50°09'41.27446" W	889.806	MEIOFIO
P284	25°07'05.19146" S	50°09'41.30131" W	889.747	VIAPAV
P285	25°07'05.21954" S	50°09'41.39146" W	889.817	VIAPAV
P286	25°07'05.25874" S	50°09'41.48303" W	889.867	VIAPAV
P287	25°07'05.26708" S	50°09'41.50793" W	889.971	MEIOFIO
P288	25°07'04.81188" S	50°09'41.66190" W	888.586	MEIOFIO
P289	25°07'04.80479" S	50°09'41.62799" W	888.506	VIAPAV
P290	25°07'04.80476" S	50°09'41.53012" W	888.586	VIAPAV
P291	25°07'04.78032" S	50°09'41.43380" W	888.593	VIAPAV
P292	25°07'04.77545" S	50°09'41.41259" W	888.684	MEIOFIO
P293	25°07'04.96024" S	50°09'41.26432" W	888.750	POSTE
P294	25°07'04.97778" S	50°09'41.16322" W	887.989	LOTE
P295	25°07'04.31304" S	50°09'41.39514" W	887.144	ESQUINA
P296	25°07'04.34948" S	50°09'41.55547" W	887.367	MEIOFIO
P297	25°07'04.24653" S	50°09'41.55610" W	887.213	MEIOFIO
P298	25°07'04.21068" S	50°09'41.54027" W	887.182	MEIOFIO





IDENTIF.	LATITUDE	LONGITUDE	COTA	DESCRIÇÃO
P299	25°07'04.18233" S	50°09'41.51629" W	887.030	MEIOFIO
P300	25°07'04.12313" S	50°09'41.45350" W	886.894	MEIOFIO
P301	25°07'03.84188" S	50°09'41.55332" W	886.608	MEIOFIO
P302	25°07'03.88384" S	50°09'41.59774" W	886.638	MEIOFIO
P303	25°07'03.89774" S	50°09'41.67656" W	886.434	MEIOFIO
P304	25°07'03.83487" S	50°09'41.76404" W	886.053	MEIOFIO
P305	25°07'03.76535" S	50°09'41.64472" W	886.429	ESQUINA
P306	25°07'03.82680" S	50°09'41.62338" W	886.494	PVTELEF
P307	25°07'03.84055" S	50°09'41.60704" W	886.474	PVTELEF
P308	25°07'03.84856" S	50°09'41.62641" W	886.495	PVTELEF
P309	25°07'04.27473" S	50°09'41.60461" W	887.208	VIAPAV
P310	25°07'04.34808" S	50°09'41.68124" W	887.361	VIAPAV
P311	25°07'04.44144" S	50°09'41.77815" W	887.438	VIAPAV
P312	25°07'04.56946" S	50°09'41.85819" W	887.707	PVSANEP
P313	25°07'04.62970" S	50°09'41.90441" W	887.836	ESQUINA
P314	25°07'04.56167" S	50°09'41.92330" W	887.409	MEIOFIO
P315	25°07'04.55452" S	50°09'41.77413" W	887.741	MEIOFIO
P316	25°07'04.59059" S	50°09'41.73643" W	887.885	MEIOFIO
P317	25°07'04.75318" S	50°09'41.70482" W	888.333	BOCALOBO
P318	25°07'04.78131" S	50°09'41.69435" W	888.438	BOCALOBO
P319	25°07'04.76998" S	50°09'41.65793" W	888.376	BOCALOBO
P320	25°07'04.74236" S	50°09'41.66591" W	888.276	BOCALOBO
P321	25°07'04.64628" S	50°09'41.47221" W	888.226	BOCALOBO
P322	25°07'04.67316" S	50°09'41.46024" W	888.294	BOCALOBO
P323	25°07'04.66264" S	50°09'41.42239" W	888.211	BOCALOBO
P324	25°07'04.63561" S	50°09'41.43129" W	888.189	BOCALOBO
P325	25°07'05.24866" S	50°09'41.67838" W	890.773	LOTE



IDENTIF.	LATITUDE	LONGITUDE	COTA	DESCRIÇÃO
P326	25°07'05.74646" S	50°09'41.48605" W	891.309	LOTE
P327	25°07'06.27084" S	50°09'41.30351" W	891.715	LOTE
P328	25°07'06.30784" S	50°09'41.34457" W	891.738	LOTE
P329	25°07'06.56971" S	50°09'41.22517" W	891.989	LOTE
P330	25°07'06.81843" S	50°09'41.10899" W	893.997	LOTE
P331	25°07'06.86761" S	50°09'41.15993" W	894.133	LOTE
P332	25°07'06.94980" S	50°09'41.06417" W	894.546	LOTE
P333	25°07'06.96921" S	50°09'41.00088" W	894.797	POSTE
P334	25°07'06.76687" S	50°09'41.05132" W	893.688	CINAMOMO
P335	25°07'06.74583" S	50°09'41.05132" W	893.520	CINAMOMO
P336	25°07'06.75330" S	50°09'41.03167" W	893.791	CINAMOMO
P337	25°07'06.74666" S	50°09'41.00222" W	893.702	MEIOFIO
P338	25°07'06.77280" S	50°09'41.05999" W	893.594	MEIOFIO
P339	25°07'06.93977" S	50°09'40.99194" W	894.582	MEIOFIO
P340	25°07'07.05099" S	50°09'40.98757" W	894.971	MEIOFIO
P341	25°07'07.19561" S	50°09'40.97909" W	895.116	MEIOFIO
P342	25°07'07.36877" S	50°09'40.97005" W	895.162	MEIOFIO
P343	25°07'07.58759" S	50°09'40.95920" W	895.249	MEIOFIO
P344	25°07'07.58837" S	50°09'41.02772" W	895.248	LOTE
P345	25°07'07.58675" S	50°09'40.91989" W	895.261	VIAPAV
P346	25°07'07.58154" S	50°09'40.79159" W	895.482	VIAPAV
P347	25°07'07.50418" S	50°09'40.67261" W	895.349	VIAPAV
P348	25°07'07.46929" S	50°09'40.58619" W	895.583	POSTE
P349	25°07'07.36807" S	50°09'40.65219" W	895.238	VIAPAV
P350	25°07'07.13726" S	50°09'40.54364" W	894.981	VIAPAV
P351	25°07'06.94756" S	50°09'40.42671" W	894.777	VIAPAV
P352	25°07'07.17170" S	50°09'40.36062" W	895.523	CERCA



IDENTIF.	LATITUDE	LONGITUDE	COTA	DESCRIÇÃO
P353	25°07'06.92700" S	50°09'40.72929" W	894.806	VIAPAV
P354	25°07'06.97129" S	50°09'40.79879" W	894.851	VIAPAV
P355	25°07'07.02375" S	50°09'40.94726" W	894.813	VIAPAV
P356	25°07'07.00899" S	50°09'40.95222" W	894.824	PVSANEP
P357	25°07'06.99934" S	50°09'40.93700" W	894.796	PVSANEP
P358	25°07'06.99186" S	50°09'40.95323" W	894.787	PVSANEP
P359	25°07'07.22203" S	50°09'40.93731" W	895.045	VIAPAV
P360	25°07'07.45266" S	50°09'40.92745" W	895.153	VIAPAV
P361	25°07'07.58705" S	50°09'40.92628" W	895.298	MEIOFIO
P362	25°07'07.78061" S	50°09'40.91571" W	895.679	MEIOFIO
P363	25°07'07.79312" S	50°09'40.90324" W	895.663	BOCALOBO
P364	25°07'07.82424" S	50°09'40.89981" W	895.723	BOCALOBO
P365	25°07'07.82901" S	50°09'40.94430" W	895.873	BOCALOBO
P366	25°07'07.79535" S	50°09'40.94675" W	895.787	BOCALOBO
P367	25°07'07.94663" S	50°09'41.01320" W	896.293	LOTE
P368	25°07'07.84128" S	50°09'40.91083" W	895.778	MEIOFIO
P369	25°07'08.12566" S	50°09'40.89290" W	896.191	MEIOFIO
P370	25°07'08.17915" S	50°09'41.00387" W	896.525	LOTE
P371	25°07'08.11535" S	50°09'40.86801" W	896.169	VIAPAV
P372	25°07'08.10390" S	50°09'40.76386" W	896.257	VIAPAV
P373	25°07'08.10052" S	50°09'40.63705" W	896.230	VIAPAV
P374	25°07'08.40798" S	50°09'40.61924" W	896.631	VIAPAV
P375	25°07'08.40338" S	50°09'40.74281" W	896.689	VIAPAV
P376	25°07'08.40503" S	50°09'40.85525" W	896.576	VIAPAV
P377	25°07'08.43474" S	50°09'40.87254" W	896.640	MEIOFIO
P378	25°07'08.42840" S	50°09'40.99288" W	896.746	LOTE
P379	25°07'08.82187" S	50°09'40.97759" W	897.160	LOTE



IDENTIF.	LATITUDE	LONGITUDE	COTA	DESCRIÇÃO
P380	25°07'08.81793" S	50°09'40.85021" W	897.103	MEIOFIO
P381	25°07'08.81835" S	50°09'40.82625" W	897.098	VIAPAV
P382	25°07'08.81395" S	50°09'40.72152" W	897.193	VIAPAV
P383	25°07'08.80463" S	50°09'40.59693" W	897.145	VIAPAV
P384	25°07'08.68579" S	50°09'40.52957" W	897.412	POSTE
P385	25°07'09.07630" S	50°09'40.58418" W	897.429	VIAPAV
P386	25°07'09.07713" S	50°09'40.70294" W	897.487	VIAPAV
P387	25°07'09.07404" S	50°09'40.81054" W	897.398	VIAPAV
P388	25°07'09.21273" S	50°09'40.82877" W	897.550	MEIOFIO
P389	25°07'09.22479" S	50°09'40.96138" W	897.582	LOTE
P390	25°07'09.46671" S	50°09'40.83836" W	897.884	ARVORE
P391	25°07'09.44369" S	50°09'40.84391" W	897.852	ARVORE
P392	25°07'09.46328" S	50°09'40.87587" W	897.859	ARVORE
P393	25°07'09.55668" S	50°09'40.80757" W	897.929	MEIOFIO
P394	25°07'09.55308" S	50°09'40.78049" W	897.882	VIAPAV
P395	25°07'09.54554" S	50°09'40.67646" W	897.928	VIAPAV
P396	25°07'09.53815" S	50°09'40.56032" W	897.843	VIAPAV
P397	25°07'09.51047" S	50°09'40.38522" W	898.096	CERCA
P398	25°07'09.10566" S	50°09'40.40066" W	897.899	CERCA
P399	25°07'08.69906" S	50°09'40.41657" W	897.490	CERCA
P400	25°07'07.97546" S	50°09'40.44362" W	896.624	CERCA
P401	25°07'07.72140" S	50°09'40.45424" W	896.271	CERCA
P402	25°07'08.79737" S	50°09'34.08120" W	903.322	CERCA
P403	25°07'08.59346" S	50°09'34.25074" W	903.093	CERCA
P404	25°07'08.51624" S	50°09'34.31126" W	902.873	CERCA
P405	25°07'08.16077" S	50°09'34.41203" W	902.692	CERCA
P406	25°07'07.77494" S	50°09'34.50665" W	902.097	CERCA



IDENTIF.	LATITUDE	LONGITUDE	COTA	DESCRIÇÃO
P407	25°07'07.35413" S	50°09'34.62004" W	901.507	CERCA
P408	25°07'06.94625" S	50°09'34.73120" W	900.770	CERCA
P409	25°07'06.70773" S	50°09'34.79411" W	900.575	CERCA
P410	25°07'06.71564" S	50°09'34.80148" W	900.711	EUCALIPT [ [ [
P411	25°07'06.75366" S	50°09'34.80411" W	900.744	EUCALIPT [ [ [
P412	25°07'06.75184" S	50°09'34.83305" W	900.683	EUCALIPT [ [ [
P413	25°07'06.64088" S	50°09'34.81353" W	900.396	EUCALIPT [ [ [
P414	25°07'06.64289" S	50°09'34.83140" W	900.522	EUCALIPT [ [ [
P415	25°07'05.95643" S	50°09'35.49079" W	898.868	EUCALIPT [ [ [
P416	25°07'05.96219" S	50°09'35.46850" W	898.935	EUCALIPT [ [ [
P417	25°07'05.93664" S	50°09'35.46339" W	898.742	EUCALIPT [ [ [
P418	25°07'05.19616" S	50°09'35.50459" W	897.743	VIANPAV
P419	25°07'05.18850" S	50°09'35.41637" W	897.759	VIANPAV
P420	25°07'05.15572" S	50°09'35.32680" W	897.775	VIANPAV
P421	25°07'05.29209" S	50°09'35.29248" W	898.434	TRILHO
P422	25°07'05.33350" S	50°09'35.47508" W	898.452	TRILHO
P423	25°07'05.36072" S	50°09'35.42527" W	898.447	TRILHO
P424	25°07'05.47330" S	50°09'35.45285" W	898.482	VIANPAV
P425	25°07'05.45347" S	50°09'35.33383" W	898.548	VIANPAV
P426	25°07'05.44808" S	50°09'35.23674" W	898.539	VIANPAV
P427	25°07'05.76301" S	50°09'35.13657" W	898.649	VIANPAV
P428	25°07'05.79074" S	50°09'35.24461" W	898.679	VIANPAV
P429	25°07'05.82628" S	50°09'35.35613" W	898.604	VIANPAV
P430	25°07'06.12421" S	50°09'35.27775" W	898.905	VIANPAV
P431	25°07'06.12179" S	50°09'35.17804" W	898.993	VIANPAV
P432	25°07'06.11595" S	50°09'35.03625" W	899.003	VIANPAV
P433	25°07'06.41208" S	50°09'35.00266" W	899.508	VIANPAV





IDENTIF.	LATITUDE	LONGITUDE	COTA	DESCRIÇÃO
P434	25°07'06.43590" S	50°09'35.09344" W	899.441	VIANPAV
P435	25°07'06.46957" S	50°09'35.19562" W	899.314	VIANPAV
P436	25°07'06.78604" S	50°09'35.09112" W	899.878	VIANPAV
P437	25°07'06.77643" S	50°09'34.99474" W	900.104	VIANPAV
P438	25°07'06.76862" S	50°09'34.90246" W	900.098	VIANPAV
P439	25°07'07.07170" S	50°09'34.81058" W	900.438	VIANPAV
P440	25°07'07.08938" S	50°09'34.90665" W	900.428	VIANPAV
P441	25°07'07.12243" S	50°09'35.00166" W	900.263	VIANPAV
P442	25°07'07.41511" S	50°09'34.91625" W	900.561	VIANPAV
P443	25°07'07.40283" S	50°09'34.81978" W	900.790	VIANPAV
P444	25°07'07.38613" S	50°09'34.71863" W	900.801	VIANPAV
P445	25°07'07.68947" S	50°09'34.63792" W	901.187	VIANPAV
P446	25°07'07.70993" S	50°09'34.72727" W	901.169	VIANPAV
P447	25°07'07.73448" S	50°09'34.81315" W	900.986	VIANPAV
P448	25°07'08.03533" S	50°09'34.73497" W	901.432	VIANPAV
P449	25°07'08.02163" S	50°09'34.64176" W	901.562	VIANPAV
P450	25°07'08.00389" S	50°09'34.55040" W	901.565	VIANPAV
P451	25°07'08.31552" S	50°09'34.46425" W	901.805	VIANPAV
P452	25°07'08.33486" S	50°09'34.54981" W	901.911	VIANPAV
P453	25°07'08.35181" S	50°09'34.64421" W	901.851	VIANPAV
P454	25°07'08.63878" S	50°09'34.58419" W	902.217	VIANPAV
P455	25°07'08.63512" S	50°09'34.48791" W	902.353	VIANPAV
P456	25°07'08.61948" S	50°09'34.36658" W	902.274	VIANPAV
P457	25°07'08.85004" S	50°09'34.27752" W	902.932	VIAPAV
P458	25°07'08.86532" S	50°09'34.41474" W	902.917	VIAPAV
P459	25°07'08.93704" S	50°09'34.57058" W	902.854	VIAPAV
P460	25°07'08.55095" S	50°09'34.88895" W	902.648	CERCA



IDENTIF.	LATITUDE	LONGITUDE	COTA	DESCRIÇÃO
P461	25°07'08.13137" S	50°09'35.00062" W	901.815	CERCA
P462	25°07'07.76259" S	50°09'35.09773" W	901.533	CERCA
P463	25°07'07.28750" S	50°09'35.22420" W	900.818	CERCA
P464	25°07'06.97364" S	50°09'35.30669" W	900.388	CERCA
P465	25°07'06.49927" S	50°09'35.43426" W	899.764	CERCA
P466	25°07'07.30630" S	50°09'35.21947" W	900.831	CAPAO
P467	25°07'07.70465" S	50°09'34.95979" W	901.371	CAPAO
P468	25°07'07.84941" S	50°09'34.90721" W	901.667	CAPAO
P469	25°07'08.17645" S	50°09'34.78006" W	902.119	CAPAO
P470	25°07'08.61052" S	50°09'34.69558" W	903.135	CAPAO
P471	25°07'08.71059" S	50°09'34.84672" W	902.815	CAPAO
P472	25°07'09.00278" S	50°09'34.58256" W	903.019	VIAPAV
P473	25°07'09.06399" S	50°09'34.61717" W	903.153	VIAPAV
P474	25°07'09.09772" S	50°09'34.65325" W	903.165	VIAPAV
P475	25°07'09.14359" S	50°09'34.83162" W	903.117	VIAPAV
P476	25°07'09.17953" S	50°09'34.99530" W	903.054	VIAPAV
P477	25°07'09.02655" S	50°09'35.03109" W	902.955	POSTE
P478	25°07'09.28157" S	50°09'34.95494" W	903.199	VIAPAV
P479	25°07'09.39078" S	50°09'34.91077" W	903.266	VIAPAV
P480	25°07'09.31471" S	50°09'34.62392" W	903.369	VIAPAV
P481	25°07'09.21545" S	50°09'34.64455" W	903.322	VIAPAV
P482	25°07'09.25017" S	50°09'34.32334" W	903.439	VIAPAV
P483	25°07'09.03949" S	50°09'34.37153" W	903.316	VIAPAV
P484	25°07'08.92550" S	50°09'34.20405" W	903.153	VIAPAV
P485	25°07'08.97923" S	50°09'34.09860" W	903.406	VIAPAV
P486	25°07'08.93694" S	50°09'33.92224" W	903.471	VIAPAV
P487	25°07'09.05214" S	50°09'33.90182" W	903.635	VIAPAV



IDENTIF.	LATITUDE	LONGITUDE	COTA	DESCRIÇÃO
P488	25°07'09.14668" S	50°09'33.87960" W	903.646	VIAPAV
P489	25°07'09.24733" S	50°09'33.85270" W	903.914	POSTE
P490	25°07'09.17005" S	50°09'33.87373" W	903.757	MEIOFIO
P491	25°07'09.22642" S	50°09'34.13651" W	903.621	MEIOFIO
P492	25°07'09.28829" S	50°09'34.41346" W	903.524	MEIOFIO
P493	25°07'09.35287" S	50°09'34.70828" W	903.451	MEIOFIO
P494	25°07'09.38988" S	50°09'34.82065" W	903.436	MEIOFIO
P495	25°07'09.43346" S	50°09'34.90480" W	903.344	MEIOFIO
P496	25°07'09.47423" S	50°09'34.94430" W	903.328	MEIOFIO
P497	25°07'09.52598" S	50°09'34.95587" W	903.308	MEIOFIO
P498	25°07'09.58092" S	50°09'34.95592" W	903.307	MEIOFIO
P499	25°07'09.50701" S	50°09'34.92326" W	903.361	PVSANEP
P500	25°07'09.49801" S	50°09'34.90746" W	903.381	PVSANEP
P501	25°07'09.49011" S	50°09'34.92441" W	903.373	PVSANEP
P502	25°07'09.44349" S	50°09'34.77001" W	903.437	EXTREMOS [ [ [
P503	25°07'09.38560" S	50°09'34.49585" W	903.618	EXTREMOS [ [ [
P504	25°07'09.34369" S	50°09'34.28735" W	903.751	EXTREMOS [ [ [
P505	25°07'09.34620" S	50°09'34.10626" W	903.916	LOTE
P506	25°07'08.86809" S	50°09'33.60638" W	903.652	VIAPAV
P507	25°07'08.98123" S	50°09'33.58090" W	903.813	VIAPAV
P508	25°07'09.07916" S	50°09'33.55402" W	903.821	VIAPAV
P509	25°07'09.01336" S	50°09'33.26063" W	903.977	VIAPAV
P510	25°07'08.91935" S	50°09'33.29020" W	903.958	VIAPAV
P511	25°07'08.80554" S	50°09'33.31419" W	903.855	VIAPAV
P512	25°07'08.74560" S	50°09'33.04076" W	904.035	VIAPAV
P513	25°07'08.85662" S	50°09'33.02407" W	904.099	VIAPAV
P514	25°07'08.95498" S	50°09'32.99876" W	904.085	VIAPAV



IDENTIF.	LATITUDE	LONGITUDE	COTA	DESCRIÇÃO
P515	25°07'08.86518" S	50°09'32.59567" W	904.265	VIAPAV
P516	25°07'08.76564" S	50°09'32.61235" W	904.307	VIAPAV
P517	25°07'08.65718" S	50°09'32.64544" W	904.239	VIAPAV
P518	25°07'08.59753" S	50°09'32.38276" W	904.372	VIAPAV
P519	25°07'08.70973" S	50°09'32.35635" W	904.456	VIAPAV
P520	25°07'08.82123" S	50°09'32.33191" W	904.402	VIAPAV
P521	25°07'08.75760" S	50°09'32.04919" W	904.566	VIAPAV
P522	25°07'08.64792" S	50°09'32.07451" W	904.626	VIAPAV
P523	25°07'08.53768" S	50°09'32.10729" W	904.550	VIAPAV
P524	25°07'08.47479" S	50°09'31.82399" W	904.733	VIAPAV
P525	25°07'08.58718" S	50°09'31.80219" W	904.790	VIAPAV
P526	25°07'08.69793" S	50°09'31.77697" W	904.751	VIAPAV
P527	25°07'08.65370" S	50°09'31.56900" W	904.936	VIAPAV
P528	25°07'08.53916" S	50°09'31.60045" W	904.940	VIAPAV
P529	25°07'08.43054" S	50°09'31.63426" W	904.844	VIAPAV
P530	25°07'08.76666" S	50°09'31.56633" W	904.895	PVSANEP
P531	25°07'08.76258" S	50°09'31.58718" W	904.895	PVSANEP
P532	25°07'08.77968" S	50°09'31.58127" W	904.908	PVSANEP
P533	25°07'08.80328" S	50°09'31.60996" W	904.878	LOTE
P534	25°07'08.79046" S	50°09'31.52725" W	904.904	MEIOFIO
P535	25°07'08.73411" S	50°09'31.55352" W	904.926	MEIOFIO
P536	25°07'08.70064" S	50°09'31.60245" W	904.998	MEIOFIO
P537	25°07'08.68334" S	50°09'31.64710" W	904.829	MEIOFIO
P538	25°07'08.74394" S	50°09'31.63101" W	904.840	MEIOFIO
P539	25°07'08.82550" S	50°09'32.01855" W	904.643	MEIOFIO
P540	25°07'08.91327" S	50°09'32.12675" W	904.915	LOTE
P541	25°07'08.88943" S	50°09'32.33659" W	904.532	MEIOFIO



IDENTIF.	LATITUDE	LONGITUDE	COTA	DESCRIÇÃO
P542	25°07'08.92829" S	50°09'32.44216" W	904.555	POSTE
P543	25°07'09.00786" S	50°09'32.56013" W	904.535	LOTE
P544	25°07'08.93928" S	50°09'32.57549" W	904.441	MEIOFIO
P545	25°07'08.88539" S	50°09'32.58875" W	904.301	MEIOFIO
P546	25°07'08.98152" S	50°09'33.02272" W	904.191	MEIOFIO
P547	25°07'09.10078" S	50°09'32.98120" W	904.582	LOTE
P548	25°07'09.19399" S	50°09'33.40669" W	904.381	LOTE
P549	25°07'09.07308" S	50°09'33.43965" W	904.002	MEIOFIO
P550	25°07'09.13910" S	50°09'33.74222" W	903.829	MEIOFIO
P551	25°07'09.51126" S	50°09'34.84131" W	903.401	LOTE
P552	25°07'09.83895" S	50°09'34.88689" W	903.347	MEIOFIO
P553	25°07'09.84425" S	50°09'34.91135" W	903.237	VIAPAV
P554	25°07'09.87200" S	50°09'35.04584" W	903.327	VIAPAV
P555	25°07'09.90212" S	50°09'35.19872" W	903.073	VIAPAV
P556	25°07'10.01499" S	50°09'35.19816" W	903.293	MEIOFIO
P557	25°07'10.03182" S	50°09'35.28246" W	903.318	LOTE
P558	25°07'09.63593" S	50°09'35.38675" W	903.226	LOTE
P559	25°07'09.57190" S	50°09'35.37208" W	902.894	PVSANEP
P560	25°07'09.55626" S	50°09'35.36548" W	902.918	PVSANEP
P561	25°07'09.55907" S	50°09'35.38413" W	902.888	PVSANEP
P562	25°07'09.59646" S	50°09'35.44333" W	902.708	POSTE
P563	25°07'09.52220" S	50°09'35.45294" W	902.858	MEIOFIO
P564	25°07'09.52804" S	50°09'35.36528" W	902.971	MEIOFIO
P565	25°07'09.57082" S	50°09'35.31282" W	903.125	MEIOFIO
P566	25°07'09.55416" S	50°09'35.27622" W	902.970	VIAPAV
P567	25°07'09.52408" S	50°09'35.13671" W	903.141	VIAPAV
P568	25°07'09.50556" S	50°09'34.98979" W	903.196	VIAPAV





IDENTIF.	LATITUDE	LONGITUDE	COTA	DESCRIÇÃO
P569	25°07'09.60440" S	50°09'34.87649" W	903.364	CEDRO
P570	25°07'09.77990" S	50°09'34.82805" W	903.439	CEDRO
P571	25°07'09.82575" S	50°09'34.81335" W	903.461	POSTE
P572	25°07'10.30416" S	50°09'34.62508" W	903.640	LOTE
P573	25°07'10.34225" S	50°09'34.74926" W	903.451	MEIOFIO
P574	25°07'10.34529" S	50°09'34.77455" W	903.372	VIAPAV
P575	25°07'10.38238" S	50°09'34.90663" W	903.441	VIAPAV
P576	25°07'10.40952" S	50°09'35.07088" W	903.248	VIAPAV
P577	25°07'10.31167" S	50°09'35.20920" W	903.354	LOTE
P578	25°07'10.68038" S	50°09'35.11166" W	903.423	LOTE
P579	25°07'10.66298" S	50°09'35.02897" W	903.427	MEIOFIO
P580	25°07'10.73193" S	50°09'34.64390" W	903.472	MEIOFIO
P581	25°07'10.70079" S	50°09'34.51999" W	903.825	LOTE
P582	25°07'10.73451" S	50°09'34.66984" W	903.452	VIAPAV
P583	25°07'10.76742" S	50°09'34.80284" W	903.549	VIAPAV
P584	25°07'10.80745" S	50°09'34.96003" W	903.367	VIAPAV
P585	25°07'11.18131" S	50°09'34.97326" W	903.664	LOTE
P586	25°07'11.16285" S	50°09'34.88776" W	903.652	MEIOFIO
P587	25°07'11.11642" S	50°09'34.53696" W	903.620	MEIOFIO
P588	25°07'11.11085" S	50°09'34.46537" W	903.583	POSTE
P589	25°07'11.08393" S	50°09'34.41967" W	903.876	LOTE
P590	25°07'11.47178" S	50°09'34.31950" W	903.843	LOTE
P591	25°07'11.50073" S	50°09'34.43218" W	903.723	MEIOFIO
P592	25°07'11.50549" S	50°09'34.45696" W	903.608	VIAPAV
P593	25°07'11.53807" S	50°09'34.60142" W	903.724	VIAPAV
P594	25°07'11.57030" S	50°09'34.75268" W	903.581	VIAPAV
P595	25°07'11.67950" S	50°09'34.83991" W	903.702	LOTE



IDENTIF.	LATITUDE	LONGITUDE	COTA	DESCRIÇÃO
P596	25°07'11.66340" S	50°09'34.75682" W	903.722	MEIOFIO
P597	25°07'11.88913" S	50°09'34.32429" W	903.839	MEIOFIO
P598	25°07'11.86525" S	50°09'34.21847" W	903.899	LOTE
P599	25°07'12.25294" S	50°09'34.11288" W	904.267	LOTE
P600	25°07'12.28316" S	50°09'34.21419" W	903.858	MEIOFIO
P601	25°07'12.28922" S	50°09'34.24585" W	903.655	VIAPAV
P602	25°07'12.31867" S	50°09'34.41023" W	903.767	VIAPAV
P603	25°07'12.34741" S	50°09'34.54943" W	903.632	VIAPAV
P604	25°07'12.17997" S	50°09'34.71226" W	903.732	LOTE
P605	25°07'13.21545" S	50°09'34.43612" W	903.357	ESQUINA
P606	25°07'13.09113" S	50°09'33.88636" W	904.022	ESQUINA
P607	25°07'09.36846" S	50°09'35.33666" W	902.948	VIAPAV
P608	25°07'09.26335" S	50°09'35.35959" W	902.837	VIAPAV
P609	25°07'09.32585" S	50°09'35.64339" W	902.591	VIAPAV
P610	25°07'09.43020" S	50°09'35.61990" W	902.682	VIAPAV
P611	25°07'09.53396" S	50°09'35.59401" W	902.608	VIAPAV
P612	25°07'09.59619" S	50°09'35.89453" W	902.322	VIAPAV
P613	25°07'09.49601" S	50°09'35.90886" W	902.398	VIAPAV
P614	25°07'09.38742" S	50°09'35.92902" W	902.320	VIAPAV
P615	25°07'09.45035" S	50°09'36.23236" W	902.031	VIAPAV
P616	25°07'09.56202" S	50°09'36.20917" W	902.113	VIAPAV
P617	25°07'09.66201" S	50°09'36.18445" W	902.043	VIAPAV
P618	25°07'09.72811" S	50°09'36.48512" W	901.829	VIAPAV
P619	25°07'09.62777" S	50°09'36.50520" W	901.865	VIAPAV
P620	25°07'09.51715" S	50°09'36.52863" W	901.767	VIAPAV
P621	25°07'09.58454" S	50°09'36.83357" W	901.512	VIAPAV
P622	25°07'09.79429" S	50°09'36.78283" W	901.627	VIAPAV



IDENTIF.	LATITUDE	LONGITUDE	COTA	DESCRIÇÃO
P623	25°07'09.85383" S	50°09'37.07711" W	901.441	VIAPAV
P624	25°07'09.75682" S	50°09'37.09363" W	901.439	VIAPAV
P625	25°07'09.64918" S	50°09'37.11747" W	901.346	VIAPAV
P626	25°07'09.71622" S	50°09'37.43292" W	901.146	VIAPAV
P627	25°07'09.82602" S	50°09'37.40788" W	901.229	VIAPAV
P628	25°07'09.92828" S	50°09'37.38190" W	901.221	VIAPAV
P629	25°07'09.95614" S	50°09'37.46206" W	901.143	VIAPAV
P630	25°07'10.01685" S	50°09'37.74087" W	900.921	VIAPAV
P631	25°07'09.90494" S	50°09'37.76185" W	900.964	VIAPAV
P632	25°07'09.80036" S	50°09'37.81891" W	900.867	VIAPAV
P633	25°07'09.88702" S	50°09'38.20232" W	900.607	VIAPAV
P634	25°07'09.99649" S	50°09'38.17514" W	900.693	VIAPAV
P635	25°07'10.10719" S	50°09'38.15414" W	900.669	VIAPAV
P636	25°07'10.13489" S	50°09'38.21198" W	900.550	VIANPAV
P637	25°07'10.00851" S	50°09'38.23130" W	900.680	VIANPAV
P638	25°07'09.88064" S	50°09'38.26370" W	900.544	VIANPAV
P639	25°07'09.94704" S	50°09'38.55941" W	900.278	VIANPAV
P640	25°07'10.07599" S	50°09'38.54499" W	900.422	VIANPAV
P641	25°07'10.18155" S	50°09'38.51796" W	900.423	VIANPAV
P642	25°07'10.25006" S	50°09'38.82518" W	900.121	VIANPAV
P643	25°07'10.13613" S	50°09'38.84978" W	900.155	VIANPAV
P644	25°07'10.01110" S	50°09'38.87309" W	900.012	VIANPAV
P645	25°07'10.09383" S	50°09'39.18243" W	899.701	VIANPAV
P646	25°07'10.20259" S	50°09'39.16833" W	899.830	VIANPAV
P647	25°07'10.32655" S	50°09'39.12721" W	899.711	VIANPAV
P648	25°07'10.39028" S	50°09'39.42964" W	899.449	VIANPAV
P649	25°07'10.26867" S	50°09'39.46493" W	899.590	VIANPAV



IDENTIF.	LATITUDE	LONGITUDE	COTA	DESCRIÇÃO
P650	25°07'10.15183" S	50°09'39.49308" W	899.402	VIANPAV
P651	25°07'10.21718" S	50°09'39.78040" W	899.099	VIANPAV
P652	25°07'10.33751" S	50°09'39.74848" W	899.340	VIANPAV
P653	25°07'10.45427" S	50°09'39.72436" W	899.136	VIANPAV
P654	25°07'10.52553" S	50°09'40.08620" W	898.787	VIANPAV
P655	25°07'10.40419" S	50°09'40.10099" W	898.922	VIANPAV
P656	25°07'10.26667" S	50°09'40.10996" W	898.752	VIANPAV
P657	25°07'10.62610" S	50°09'40.23906" W	898.902	POSTE
P658	25°07'10.26124" S	50°09'38.54177" W	900.341	PVSANEP
P659	25°07'10.29005" S	50°09'38.53725" W	900.354	PVSANEP
P660	25°07'10.27036" S	50°09'38.51103" W	900.393	PVSANEP
P661	25°07'10.33588" S	50°09'38.25520" W	900.598	LOTE
P662	25°07'10.28661" S	50°09'38.26297" W	900.535	LOTE
P663	25°07'10.24644" S	50°09'38.16147" W	900.629	LOTE
P664	25°07'10.13902" S	50°09'37.69026" W	901.098	LOTE
P665	25°07'10.17107" S	50°09'37.99334" W	900.840	POSTE
P666	25°07'10.10053" S	50°09'37.51774" W	901.267	MEIOFIO
P667	25°07'10.02274" S	50°09'37.50588" W	901.269	MEIOFIO
P668	25°07'09.96139" S	50°09'37.44809" W	901.253	MEIOFIO
P669	25°07'09.88039" S	50°09'37.08957" W	901.497	MEIOFIO
P670	25°07'09.99768" S	50°09'37.05481" W	901.605	LOTE
P671	25°07'09.88303" S	50°09'36.70649" W	901.849	POSTE
P672	25°07'09.88551" S	50°09'36.53482" W	901.959	LOTE
P673	25°07'09.76685" S	50°09'36.56338" W	901.866	MEIOFIO
P674	25°07'09.65366" S	50°09'36.05325" W	902.255	MEIOFIO
P675	25°07'09.77074" S	50°09'36.01703" W	902.242	LOTE
P676	25°07'09.57521" S	50°09'35.68614" W	902.628	MEIOFIO



IDENTIF.	LATITUDE	LONGITUDE	COTA	DESCRIÇÃO
P677	25°07'09.04470" S	50°09'35.21640" W	902.736	CERCA
P678	25°07'09.13950" S	50°09'35.64685" W	902.488	CERCA
P679	25°07'09.23457" S	50°09'36.07965" W	902.191	CERCA
P680	25°07'09.32738" S	50°09'36.50415" W	901.672	CERCA
P681	25°07'09.42372" S	50°09'36.94222" W	901.219	CERCA
P682	25°07'09.48062" S	50°09'37.20243" W	900.976	PORTAO
P683	25°07'09.52074" S	50°09'37.38151" W	900.946	PORTAO
P684	25°07'09.61431" S	50°09'37.81272" W	900.675	CERCA
P685	25°07'09.70991" S	50°09'38.24227" W	900.298	CERCA
P686	25°07'09.80502" S	50°09'38.67621" W	900.049	CERCA
P687	25°07'09.86426" S	50°09'38.94222" W	899.999	CERCA
P688	25°07'10.52193" S	50°09'39.24357" W	899.728	POSTE
P689	25°07'10.45359" S	50°09'38.96116" W	899.980	PTOCOTA
P690	25°07'10.38741" S	50°09'38.69230" W	900.227	PTOCOTA
P691	25°07'09.78145" S	50°09'40.47392" W	897.943	POSTE
P692	25°07'09.69840" S	50°09'40.43107" W	898.283	CINAMOMO
P693	25°07'09.71272" S	50°09'40.42087" W	898.410	CINAMOMO
P694	25°07'09.70061" S	50°09'40.39599" W	898.324	CINAMOMO
P695	25°07'09.98898" S	50°09'40.53621" W	898.155	VIAPAV
P696	25°07'09.99526" S	50°09'40.65257" W	898.209	VIAPAV
P697	25°07'09.99269" S	50°09'40.76692" W	898.154	VIAPAV
P698	25°07'09.82545" S	50°09'40.79285" W	898.121	MEIOFIO
P699	25°07'09.84279" S	50°09'40.93924" W	897.970	LOTE
P700	25°07'10.32583" S	50°09'40.91948" W	898.159	ESQUINA
P701	25°07'10.31105" S	50°09'40.76675" W	898.408	MEIOFIO
P702	25°07'10.41297" S	50°09'40.80208" W	898.352	MEIOFIO
P703	25°07'10.46240" S	50°09'40.87280" W	898.323	MEIOFIO





IDENTIF.	LATITUDE	LONGITUDE	COTA	DESCRIÇÃO
P704	25°07'10.53720" S	50°09'41.21726" W	898.053	MEIOFIO
P705	25°07'10.55733" S	50°09'41.21349" W	897.971	VIAPAV
P706	25°07'10.65429" S	50°09'41.19329" W	898.102	VIAPAV
P707	25°07'10.76671" S	50°09'41.17760" W	898.100	VIAPAV
P708	25°07'10.89102" S	50°09'41.48016" W	897.723	POSTE
P709	25°07'10.86291" S	50°09'41.63839" W	897.570	VIAPAV
P710	25°07'10.65035" S	50°09'41.72586" W	897.441	VIAPAV
P711	25°07'10.75924" S	50°09'41.69541" W	897.585	VIAPAV
P712	25°07'10.47273" S	50°09'41.61895" W	897.613	LOTE
P713	25°07'10.53039" S	50°09'41.46251" W	897.754	LEUCENA
P714	25°07'10.53691" S	50°09'41.44754" W	897.774	LEUCENA
P715	25°07'10.52521" S	50°09'41.44230" W	897.755	LEUCENA
P716	25°07'10.61916" S	50°09'42.32289" W	896.511	ESQUINA
P717	25°07'10.74399" S	50°09'42.17128" W	896.726	VIAPAV
P718	25°07'10.85667" S	50°09'42.16726" W	896.823	VIAPAV
P719	25°07'10.97690" S	50°09'42.18055" W	896.809	VIAPAV
P720	25°07'11.05581" S	50°09'42.26895" W	896.647	VIAPAV
P721	25°07'11.16711" S	50°09'42.27180" W	896.641	VIAPAV
P722	25°07'11.67740" S	50°09'41.95559" W	897.118	LOTE
P723	25°07'11.70166" S	50°09'42.06034" W	897.118	MEIOFIO
P724	25°07'11.64155" S	50°09'42.09953" W	896.891	VIAPAV
P725	25°07'11.42712" S	50°09'42.17547" W	896.745	VIAPAV
P726	25°07'10.71844" S	50°09'42.34953" W	896.390	MEIOFIO
P727	25°07'10.68434" S	50°09'42.40771" W	896.265	MEIOFIO
P728	25°07'10.66339" S	50°09'42.42892" W	896.189	MEIOFIO
P729	25°07'10.63663" S	50°09'42.43921" W	896.162	MEIOFIO
P730	25°07'10.95499" S	50°09'40.78374" W	898.527	POSTE



IDENTIF.	LATITUDE	LONGITUDE	COTA	DESCRIÇÃO
P731	25°07'10.71372" S	50°09'40.91162" W	898.349	VIAPAV
P732	25°07'10.73992" S	50°09'40.80835" W	898.422	VIAPAV
P733	25°07'10.78896" S	50°09'40.72592" W	898.459	VIAPAV
P734	25°07'10.89007" S	50°09'40.65718" W	898.573	VIAPAV
P735	25°07'10.87203" S	50°09'40.54811" W	898.611	VIAPAV
P736	25°07'10.84990" S	50°09'40.42464" W	898.597	VIAPAV
P737	25°07'10.68130" S	50°09'40.46821" W	898.504	VIAPAV
P738	25°07'10.46566" S	50°09'40.51928" W	898.432	VIAPAV
P739	25°07'10.27724" S	50°09'40.51299" W	898.319	VIAPAV
P740	25°07'10.13514" S	50°09'40.51821" W	898.243	VIAPAV
P741	25°07'10.07709" S	50°09'39.90669" W	899.034	CERCA
P742	25°07'10.29864" S	50°09'40.33170" W	898.458	VIANPAV
P743	25°07'10.25624" S	50°09'40.41616" W	898.379	VIANPAV
P744	25°07'10.20672" S	50°09'40.47134" W	898.323	VIANPAV
P745	25°07'10.56750" S	50°09'40.29927" W	898.655	VIANPAV
P746	25°07'10.60382" S	50°09'40.40914" W	898.573	VIANPAV
P747	25°07'10.70233" S	50°09'40.46735" W	898.503	VIANPAV
P748	25°07'11.05411" S	50°09'40.36425" W	898.701	VIAPAV
P749	25°07'11.08643" S	50°09'40.47444" W	898.745	VIAPAV
P750	25°07'11.11369" S	50°09'40.59227" W	898.676	VIAPAV
P751	25°07'11.41468" S	50°09'40.75068" W	898.580	LOTE
P752	25°07'11.36658" S	50°09'40.50663" W	898.793	VIAPAV
P753	25°07'11.33807" S	50°09'40.39127" W	898.885	VIAPAV
P754	25°07'11.30992" S	50°09'40.27110" W	898.817	VIAPAV
P755	25°07'11.58583" S	50°09'40.17477" W	898.975	VIAPAV
P756	25°07'11.62016" S	50°09'40.28987" W	899.010	VIAPAV
P757	25°07'11.65853" S	50°09'40.40687" W	898.896	VIAPAV



IDENTIF.	LATITUDE	LONGITUDE	COTA	DESCRIÇÃO
P758	25°07'11.88898" S	50°09'40.60087" W	898.728	LOTE
P759	25°07'12.10083" S	50°09'40.42706" W	898.627	POSTE
P760	25°07'12.05492" S	50°09'40.24116" W	899.031	VIAPAV
P761	25°07'12.01214" S	50°09'40.12679" W	899.124	VIAPAV
P762	25°07'11.97057" S	50°09'40.00778" W	899.081	VIAPAV
P763	25°07'12.25190" S	50°09'39.87467" W	899.107	VIAPAV
P764	25°07'12.28996" S	50°09'39.99431" W	899.159	VIAPAV
P765	25°07'12.33114" S	50°09'40.10694" W	899.071	VIAPAV
P766	25°07'12.61415" S	50°09'39.95554" W	899.097	VIAPAV
P767	25°07'12.56680" S	50°09'39.84391" W	899.161	VIAPAV
P768	25°07'12.51714" S	50°09'39.73645" W	899.143	VIAPAV
P769	25°07'12.78226" S	50°09'39.58421" W	899.120	VIAPAV
P770	25°07'12.83159" S	50°09'39.68953" W	899.140	VIAPAV
P771	25°07'12.88561" S	50°09'39.79025" W	899.086	VIAPAV
P772	25°07'13.12395" S	50°09'39.82790" W	898.940	POSTE
P773	25°07'13.19294" S	50°09'39.58297" W	898.957	VIAPAV
P774	25°07'13.14265" S	50°09'39.48473" W	899.033	VIAPAV
P775	25°07'13.09056" S	50°09'39.38032" W	899.005	VIAPAV
P776	25°07'13.31371" S	50°09'39.22661" W	898.897	VIAPAV
P777	25°07'13.36594" S	50°09'39.33348" W	898.933	VIAPAV
P778	25°07'13.41923" S	50°09'39.42546" W	898.847	VIAPAV
P779	25°07'13.63907" S	50°09'39.26202" W	898.747	VIAPAV
P780	25°07'13.59354" S	50°09'39.17220" W	898.802	VIAPAV
P781	25°07'13.53973" S	50°09'39.07363" W	898.763	VIAPAV
P782	25°07'13.77486" S	50°09'38.88877" W	898.603	VIAPAV
P783	25°07'13.82656" S	50°09'38.99361" W	898.643	VIAPAV
P784	25°07'13.88432" S	50°09'39.10230" W	898.481	VIAPAV



IDENTIF.	LATITUDE	LONGITUDE	COTA	DESCRIÇÃO
P785	25°07'14.00926" S	50°09'39.10288" W	898.492	POSTE
P786	25°07'14.02077" S	50°09'39.02331" W	898.020	BOCALEAO
P787	25°07'14.03933" S	50°09'39.05150" W	897.956	BOCALEAO
P788	25°07'14.07417" S	50°09'39.02659" W	898.107	BOCALEAO
P789	25°07'14.06469" S	50°09'39.00005" W	898.156	BOCALEAO
P790	25°07'14.06420" S	50°09'38.94832" W	898.312	VIAPAV
P791	25°07'14.16303" S	50°09'38.91961" W	898.145	VIAPAV
P792	25°07'14.24982" S	50°09'38.94148" W	897.894	VIAPAV
P793	25°07'14.29865" S	50°09'38.99906" W	897.762	VIAPAV
P794	25°07'14.59458" S	50°09'38.71716" W	897.928	ESQUINA
P795	25°07'14.52783" S	50°09'38.65759" W	898.135	PVSANEP
P796	25°07'14.54402" S	50°09'38.64766" W	898.126	PVSANEP
P797	25°07'14.52720" S	50°09'38.63878" W	898.139	PVSANEP
P798	25°07'14.54247" S	50°09'38.58465" W	898.191	MEIOFIO
P799	25°07'14.50619" S	50°09'38.67685" W	898.135	MEIOFIO
P800	25°07'14.50427" S	50°09'38.72828" W	898.091	MEIOFIO
P801	25°07'14.00108" S	50°09'38.70933" W	898.496	VIAPAV
P802	25°07'14.05373" S	50°09'38.82055" W	898.465	VIAPAV
P803	25°07'08.61359" S	50°09'35.82898" W	901.771	CAPAO
P804	25°07'08.66580" S	50°09'36.63193" W	900.924	CAPAO
P807	25°07'08.37766" S	50°09'37.24989" W	900.335	CAPAO
P808	25°07'08.13470" S	50°09'37.83140" W	899.436	CAPAO
P809	25°07'08.04485" S	50°09'37.49358" W	899.491	CAPAO
P810	25°07'07.74415" S	50°09'36.88072" W	899.924	CAPAO
P811	25°07'07.42742" S	50°09'36.63007" W	899.777	CAPAO
P812	25°07'06.63437" S	50°09'36.05757" W	899.412	CERCA
P813	25°07'09.29261" S	50°09'38.33728" W	899.818	EUCALIPT [ [ [



IDENTIF.	LATITUDE	LONGITUDE	COTA	DESCRIÇÃO
P814	25°07'09.31339" S	50°09'38.31646" W	899.996	EUCALIPT [ [ [
P815	25°07'09.32163" S	50°09'38.33630" W	899.998	EUCALIPT [ [ [
P816	25°07'09.55807" S	50°09'38.34232" W	900.224	EUCALIPT [ [ [
P817	25°07'09.56210" S	50°09'38.32390" W	900.237	EUCALIPT [ [ [
P818	25°07'09.57319" S	50°09'38.33718" W	900.279	EUCALIPT [ [ [
P819	25°07'09.56825" S	50°09'38.18110" W	900.429	EUCALIPT [ [ [
P820	25°07'09.55686" S	50°09'38.16854" W	900.318	EUCALIPT [ [ [
P821	25°07'09.57085" S	50°09'38.16516" W	900.437	EUCALIPT [ [ [
P822	25°07'09.58808" S	50°09'38.14769" W	900.522	EUCALIPT [ [ [
P823	25°07'09.58134" S	50°09'38.12863" W	900.332	EUCALIPT [ [ [
P824	25°07'09.60985" S	50°09'38.12737" W	900.566	EUCALIPT [ [ [
P825	25°07'09.53724" S	50°09'38.10144" W	900.166	MONUMENT [ [ [
P826	25°07'09.52069" S	50°09'38.11309" W	900.170	MONUMENT [ [ [
P827	25°07'09.51183" S	50°09'38.09747" W	900.223	MONUMENT [ [ [
P828	25°07'09.52688" S	50°09'38.08612" W	900.223	MONUMENT [ [ [
P829	25°07'06.19597" S	50°09'36.76589" W	898.062	CERCA
P830	25°07'06.31112" S	50°09'36.89947" W	898.320	ARVORE
P831	25°07'06.32303" S	50°09'36.90735" W	898.322	ARVORE
P832	25°07'06.33197" S	50°09'36.89451" W	898.348	ARVORE
P833	25°07'07.15164" S	50°09'40.25253" W	895.963	CAPAO
P834	25°07'07.03872" S	50°09'39.86352" W	895.739	CAPAO
P835	25°07'07.08302" S	50°09'39.35082" W	896.248	CAPAO
P836	25°07'07.51849" S	50°09'39.20880" W	898.009	CAPAO
P837	25°07'07.96851" S	50°09'39.17463" W	898.700	CAPAO
P838	25°07'07.95277" S	50°09'38.92693" W	898.239	CAPAO
P839	25°07'07.54253" S	50°09'38.72484" W	898.161	CAPAO
P840	25°07'07.19989" S	50°09'38.42110" W	898.122	CAPAO





IDENTIF.	LATITUDE	LONGITUDE	COTA	DESCRIÇÃO
P841	25°07'06.87486" S	50°09'38.60346" W	897.929	CAPAO
P842	25°07'06.39317" S	50°09'37.93131" W	898.399	CAPAO
P843	25°07'06.02402" S	50°09'37.26390" W	898.257	CAPAO
P844	25°07'05.60240" S	50°09'36.91813" W	897.486	CERCA
P845	25°07'06.15225" S	50°09'38.07511" W	896.247	TALUDE
P846	25°07'06.45542" S	50°09'38.40133" W	896.440	TALUDE
P847	25°07'06.73923" S	50°09'38.76493" W	896.522	TALUDE
P848	25°07'07.08519" S	50°09'39.01137" W	897.188	TALUDE
P849	25°07'07.48745" S	50°09'39.31931" W	896.672	TALUDE
P850	25°07'07.92651" S	50°09'39.46171" W	897.499	TALUDE
P851	25°07'08.38446" S	50°09'39.56510" W	898.284	TALUDE
P852	25°07'08.29023" S	50°09'39.41163" W	898.748	TALUDE
P853	25°07'07.86632" S	50°09'39.21903" W	898.620	TALUDE
P854	25°07'07.44511" S	50°09'39.03530" W	898.216	TALUDE
P855	25°07'07.07642" S	50°09'38.82793" W	898.193	TALUDE
P856	25°07'06.73035" S	50°09'38.47097" W	897.821	TALUDE
P857	25°07'06.41277" S	50°09'38.14399" W	898.126	TALUDE
P858	25°07'06.13100" S	50°09'37.78513" W	898.095	TALUDE
P859	25°07'09.63747" S	50°09'39.85917" W	898.809	CAPAO
P860	25°07'09.50386" S	50°09'40.35409" W	898.112	CAPAO
P861	25°07'09.39283" S	50°09'39.88672" W	898.213	TALUDE
P862	25°07'09.50558" S	50°09'39.66978" W	899.495	TALUDE
P863	25°07'08.73820" S	50°09'39.66917" W	898.457	TALUDE
P864	25°07'08.68564" S	50°09'39.53219" W	898.896	TALUDE
StkdCT01	25°07'08.50502" S	50°09'35.05026" W	902.389	COTA
StkdCT02	25°07'08.61890" S	50°09'35.56767" W	902.219	COTA
StkdCT03	25°07'08.73484" S	50°09'36.09088" W	901.763	COTA



IDENTIF.	LATITUDE	LONGITUDE	COTA	DESCRIÇÃO
StkdCT04	25°07'08.84920" S	50°09'36.61143" W	901.243	COTA
StkdCT05	25°07'08.96352" S	50°09'37.13262" W	900.860	COTA
StkdCT06	25°07'09.07798" S	50°09'37.65256" W	900.381	COTA
StkdCT07	25°07'09.19282" S	50°09'38.17378" W	899.907	COTA
StkdCT08	25°07'09.30718" S	50°09'38.69397" W	899.656	COTA
StkdCT09	25°07'09.42189" S	50°09'39.21491" W	899.516	COTA
StkdCT10	25°07'09.53696" S	50°09'39.73509" W	899.037	COTA
StkdCT11	25°07'09.65125" S	50°09'40.25593" W	898.124	COTA
StkdCT12	25°07'09.17730" S	50°09'40.38153" W	897.970	COTA
StkdCT13	25°07'09.06291" S	50°09'39.86095" W	898.321	COTA
StkdCT14	25°07'08.94787" S	50°09'39.34076" W	898.462	COTA
StkdCT15	25°07'08.83372" S	50°09'38.82043" W	899.281	COTA
StkdCT16	25°07'08.71848" S	50°09'38.29946" W	899.426	COTA
StkdCT17	25°07'08.60399" S	50°09'37.77881" W	899.824	COTA
StkdCT18	25°07'08.48870" S	50°09'37.25862" W	900.347	COTA
StkdCT19	25°07'08.37479" S	50°09'36.73700" W	900.481	COTA
StkdCT20	25°07'08.26079" S	50°09'36.21724" W	900.914	COTA
StkdCT21	25°07'08.14614" S	50°09'35.69613" W	901.360	COTA
StkdCT22	25°07'08.03119" S	50°09'35.17530" W	901.956	COTA
StkdCT23	25°07'07.55747" S	50°09'35.30148" W	901.182	COTA
StkdCT24	25°07'07.67193" S	50°09'35.82260" W	900.692	COTA
StkdCT25	25°07'07.78632" S	50°09'36.34264" W	900.341	COTA
StkdCT26	25°07'07.90152" S	50°09'36.86332" W	899.936	COTA
StkdCT27	25°07'08.01559" S	50°09'37.38416" W	899.618	COTA
StkdCT28	25°07'08.13004" S	50°09'37.90509" W	899.306	COTA
StkdCT29	25°07'08.24498" S	50°09'38.42488" W	898.849	COTA
StkdCT30	25°07'08.35908" S	50°09'38.94568" W	898.804	COTA



IDENTIF.	LATITUDE	LONGITUDE	COTA	DESCRIÇÃO
StkdCT31	25°07'08.47382" S	50°09'39.46633" W	898.776	COTA
StkdCT32	25°07'08.58844" S	50°09'39.98723" W	897.915	COTA
StkdCT33	25°07'08.10754" S	50°09'40.12670" W	896.931	COTA
StkdCT34	25°07'08.00020" S	50°09'39.59265" W	897.486	COTA
StkdCT35	25°07'07.88542" S	50°09'39.07164" W	898.353	COTA
StkdCT36	25°07'07.76917" S	50°09'38.55061" W	898.632	COTA
StkdCT37	25°07'07.65629" S	50°09'38.03109" W	898.770	COTA
StkdCT38	25°07'07.54222" S	50°09'37.50997" W	899.092	COTA
StkdCT39	25°07'07.42774" S	50°09'36.98971" W	899.429	COTA
StkdCT40	25°07'07.31285" S	50°09'36.46864" W	899.898	COTA
StkdCT41	25°07'07.19801" S	50°09'35.94817" W	900.124	COTA
StkdCT42	25°07'07.08362" S	50°09'35.42720" W	900.388	COTA
StkdCT43	25°07'06.60960" S	50°09'35.55324" W	899.763	COTA
StkdCT44	25°07'06.72409" S	50°09'36.07392" W	899.498	COTA
StkdCT45	25°07'06.83709" S	50°09'36.59062" W	899.110	COTA
StkdCT46	25°07'06.95238" S	50°09'37.11537" W	898.885	COTA
StkdCT47	25°07'07.06713" S	50°09'37.63534" W	898.445	COTA
StkdCT48	25°07'07.18276" S	50°09'38.15637" W	898.377	COTA
StkdCT49	25°07'07.29657" S	50°09'38.67910" W	898.387	COTA
StkdCT50	25°07'07.41186" S	50°09'39.19842" W	897.723	COTA
StkdCT51	25°07'07.52569" S	50°09'39.71819" W	896.615	COTA
StkdCT52	25°07'07.64056" S	50°09'40.23844" W	896.337	COTA
StkdCT53	25°07'07.05220" S	50°09'39.84450" W	895.835	COTA
StkdCT54	25°07'06.93713" S	50°09'39.32382" W	896.109	COTA
StkdCT55	25°07'06.82299" S	50°09'38.80252" W	896.682	COTA
StkdCT56	25°07'06.70841" S	50°09'38.28241" W	898.412	COTA
StkdCT57	25°07'06.59386" S	50°09'37.76155" W	897.916	COTA



IDENTIF.	LATITUDE	LONGITUDE	COTA	DESCRIÇÃO
StkdCT58	25°07'06.47951" S	50°09'37.24143" W	898.136	COTA
StkdCT59	25°07'06.00640" S	50°09'37.36693" W	898.415	COTA
StkdCT60	25°07'06.11946" S	50°09'37.88780" W	897.084	COTA
StkdCT61	25°07'06.23475" S	50°09'38.40834" W	896.036	COTA
StkdCT62	25°07'06.34911" S	50°09'38.92859" W	895.556	COTA
StkdCT63	25°07'06.46375" S	50°09'39.44878" W	895.304	COTA
StkdCT64	25°07'05.88465" S	50°09'39.06560" W	894.429	COTA
StkdCT65	25°07'05.76132" S	50°09'38.53387" W	895.206	COTA
StkdCT66	25°07'05.65647" S	50°09'38.01604" W	895.504	COTA
StkdCT67	25°07'05.53212" S	50°09'37.49332" W	895.875	COTA
StkdCT68	25°07'05.05845" S	50°09'37.61728" W	894.626	COTA
StkdCT69	25°07'05.17171" S	50°09'38.13908" W	894.090	COTA
StkdSONDAGEM01	25°07'08.37505" S	50°09'35.81404" W	901.507	06 03 20
StkdSONDAGEM02	25°07'08.16745" S	50°09'36.27883" W	900.755	06 03 20
StkdSONDAGEM03	25°07'08.76668" S	50°09'36.65606" W	901.172	06 03 20
StkdSONDAGEM04	25°07'09.06370" S	50°09'38.48464" W	899.674	06 03 20
StkdSONDAGEM05	25°07'08.34590" S	50°09'37.61189" W	899.753	06 03 20
StkdSONDAGEM06	25°07'07.62642" S	50°09'36.81607" W	899.854	06 03 20
StkdSONDAGEM07	25°07'08.39534" S	50°09'38.66188" W	898.914	06 03 20
StkdSONDAGEM08	25°07'07.50235" S	50°09'37.92570" W	898.747	06 03 20
StkdSONDAGEM09	25°07'06.78604" S	50°09'36.23275" W	899.379	06 03 20
StkdSONDAGEM10	25°07'06.97787" S	50°09'37.32697" W	898.612	06 03 20
StkdSONDAGEM11	25°07'06.29054" S	50°09'37.78736" W	898.407	06 03 20
StkdSONDAGEM12	25°07'06.82514" S	50°09'39.11888" W	896.372	06 03 20
Z_01	25°07'02.77431" S	50°09'36.02908" W	890.284	AUXILIAR
Z_02	25°07'03.19384" S	50°09'36.57906" W	890.808	AUXILIAR
Z_03	25°07'03.99536" S	50°09'37.47593" W	891.937	AUXILIAR



IDENTIF.	LATITUDE	LONGITUDE	COTA	DESCRIÇÃO
Z_04	25°07'04.75788" S	50°09'38.30113" W	892.986	AUXILIAR
Z_05	25°07'05.54454" S	50°09'39.14048" W	893.744	AUXILIAR
Z_06	25°07'06.37386" S	50°09'40.01635" W	894.302	AUXILIAR
Z_07	25°07'07.14599" S	50°09'40.81574" W	895.090	AUXILIAR
Z_08	25°07'08.70253" S	50°09'40.72560" W	897.058	AUXILIAR
Z_09	25°07'09.79490" S	50°09'40.66254" W	898.094	AUXILIAR
Z_10	25°07'10.54551" S	50°09'40.61261" W	898.469	AUXILIAR
Z_11	25°07'09.96937" S	50°09'38.04860" W	900.766	AUXILIAR
Z_12	25°07'09.68528" S	50°09'36.75804" W	901.664	AUXILIAR
Z_13	25°07'09.41046" S	50°09'35.50870" W	902.789	AUXILIAR
Z_14	25°07'09.14683" S	50°09'34.33673" W	903.435	AUXILIAR
Z_15	25°07'08.29620" S	50°09'40.58251" W	896.668	AUXILIAR
Z_16	25°07'09.51178" S	50°09'36.80440" W	901.319	AUXILIAR

Ponta Grossa (PR), 31 de março de 2.020.

FÁBIO MOREIRA RABELO  
Engenheiro Civil  
CREA(RJ) 1994104196



ENGENHARIA  
ARQUITETURA

OBRA:

**PROJETO DE CONSTRUÇÃO DO FÓRUM  
DA COMARCA DE PONTA GROSSA**

PROPRIETÁRIO:

**TRIBUNAL DE JUSTIÇA DO ESTADO DO  
PARANÁ**

ESPECIALIDADE:

**LEVANTAMENTO PLANIALTIMÉTRICO**

ASSUNTO:

**RELATÓRIO FOTOGRÁFICO**

RESPONSÁVEL TÉCNICO:

**Eng. Fábio Moreira Rabelo  
1994104196 CREA/RJ**

CÓDIGO:

**PGR-1E-PLA-02-RELATÓRIO FOTOGRÁFICO-2020-  
04-03-R01**

REVISÃO	DESCRIÇÃO	RESPONSÁVEL	DATA
0	EMISSÃO INICIAL	FÁBIO	03/04/2020
1	REVISÃO 1	FÁBIO	10/06/2020



## ÍNDICE

<b>1. INTRODUÇÃO.....</b>	<b>3</b>
<b>2. localização terreno .....</b>	<b>3</b>
<b>3. vistas da face do terreno, vegetação, cercas, redes (elétricas).....</b>	<b>4</b>
<b>4. sistema de drenagem/águas pluviais.....</b>	<b>9</b>
<b>5. redes (elétricas) .....</b>	<b>10</b>
<b>6. interior do terreno - vegetação .....</b>	<b>11</b>

## 1. INTRODUÇÃO

O presente documento tem como objetivo apresentar o Relatório Fotográfico do terreno onde será construído o Tribunal de Justiça do Estado do Paraná – Novo Fórum Comarca de Ponta Grossa, localizado na Rua Alberto Scarpin, s/n – Oficinas – CEP: 84.045-160 – Ponta Grossa – PR.

## 2. LOCALIZAÇÃO TERRENO

As fotos estão representadas por números, e estão indicadas na planta de localização das fotos (PGR-1E-PLA-006-PLANTA LOCALIZAÇÃO FOTOS-2020-04-06\_R01) que segue anexo ao relatório fotográfico.



Figura 1 –Terreno Localizado na Rua Alberto Scarpin S/Nº - Oficinas – Ponta Grossa-PR

### 3. VISTAS DA FACE DO TERRENO, VEGETAÇÃO, CERCAS, REDES (ELÉTRICAS)



Figura 2: Vistas da face do Terreno – Esquina da Rua Carlos Vetorazzi com Rua Dr. Luiz Conrado Mansani



Figura 3: Vistas da face do Terreno – Rua Dr. Luiz Conrado Mansani





*Figura 4: Vistas da face do Terreno – Rua Dr. Luiz Conrado Mansani*

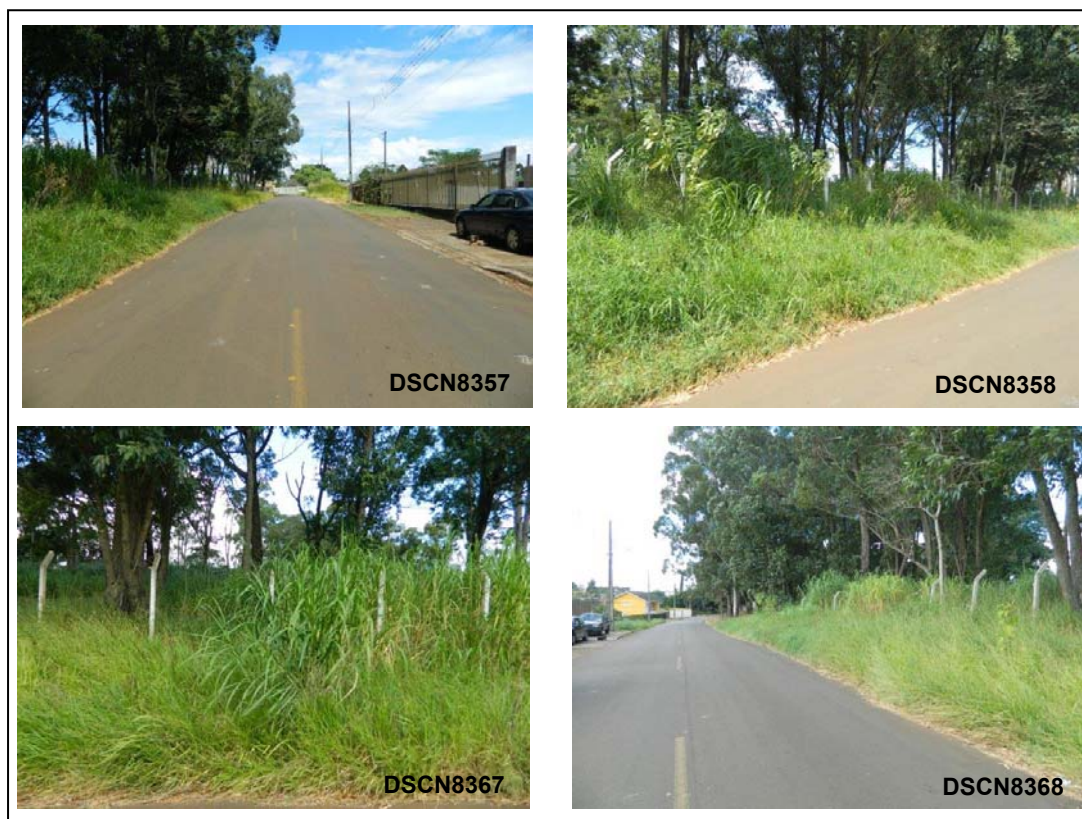

*Figura 5: Vistas da face do Terreno – Esquina da Rua Dr. Luiz Conrado Mansani com Rua Christiano Kratsch*



*Figura 6: Vistas da face do Terreno – Rua Christiano Kratsch*



*Figura 7: Vistas da face do Terreno – Esquina da Rua Christiano Kratsch com Rua Alberto Scarpin*



*Figura 8: Vistas da face do Terreno –Rua Alberto Scarpin*





*Figura 9: Vistas da face do Terreno –Rua Alberto Scarpin*



*Figura 10: Vistas da face do Terreno – Esquina da Rua Alberto Scarpin com Rua Carlos Vetorazzi*





*Figura 11: Vistas da face do Terreno – Esquina da Rua Alberto Scarpin com Rua Carlos Vetorazzi*



*Figura 12: Vistas da face do Terreno – Rua Carlos Vetorazzi*



#### 4. SISTEMA DE DRENAGEM/ÁGUAS PLUVIAIS



*Figura 13: Bocas de Lobo – Rua Carlos Vetorazzi*



*Figura 14: Bocas de Lobo –Rua Christiano Kratsch e Rua Antônio Viezer*

## 5. REDES (ELÉTRICAS)



*Figura 15: Postes – Rua Dr. Luiz Conrado Mansani*





*Figura 16: Postes – Rua Dr. Luiz Conrado Mansani e Rua Carlos Vitorazzi*



*Figura 17: Poste/Trafo – Esquina da Rua Alberto Scarpin com Rua Carlos Vitorazzi*

## 6. INTERIOR DO TERRENO - VEGETAÇÃO



*Figura 18: Vistas da Vegetação do Terreno*





*Figura 19: Vistas da Vegetação do Terreno*



## IRAPLAN TOPOGRAFIA

Rua Engenheiro Teixeira Soares, 206 – CEP 84.040-180 - Vila Estrela – Ponta Grossa – PR.  
Fone (42) 3223-2929 – E-mail: iraplantopografia@gmail.com

Ao  
Tribunal de Justiça do Estado do Paraná

Vimos, através desta, informar que a referência de nível do levantamento topográfico do TJPR de Ponta Grossa (PR) foi definida a partir de um marco cujas coordenadas foram determinadas com receptor GPS L1 e L2 em rastreamento com o conjunto de bases GPS do estado do Paraná, parte da RBMC (Rede Brasileira de Monitoramento Contínuo). O software utilizado no ajustamento foi o LEICA INFINITY e o LEICA GEO OFFICE. Essa implantação ocorreu em 29/07/2014 e este marco serve de base para demais transportes de coordenadas.

O transporte de coordenadas para o terreno do TJPR foi realizado com um par de receptores GPS, marca Leica, modelo SR-20, L1 e fase. Estes 3 pontos serviram para enquadramento do levantamento topográfico no Sistema Geodésico Brasileiro SIRGAS2000.

O edital solicitava a apresentação dos dados no Sistema Geodésico Brasileiro SAD-69. Este sistema não é o oficial e está em desuso desde o ano de 2005. Então a transformação de coordenadas foi calculada com a utilização do software POSIÇÃO, atendendo, assim, a exigência do edital.

Mantemo-nos à disposição para dirimir quaisquer outros questionamentos.

Atenciosamente

Fábio Moreira Rabelo  
Engenheiro Civil  
CREA(RJ) 1994104196